



**CITY OF
COVINGTON
KENTUCKY**

CITY OF COVINGTON, KENTUCKY

REQUEST FOR PROPOSAL

Purchase of Ambulances, FY20

Issue Date:

August 8th, 2019

Issuing Department:

Fire Department

100 East Robbins Street

Covington, KY 41011

TABLE OF CONTENTS

SECTION 1. ADVERTISEMENT	3
SECTION 2. SCHEDULE	4
SECTION 3. INSTRUCTIONS TO RESPONDENTS	5
SECTION 4. PROPOSAL FORMAT AND ATTACHMENTS	7
SECTION 5. TERMS AND CONDITIONS	13
SECTION 6. AMBULANCE SPECIFICATIONS	18

ATTACHMENTS*

RESPONDENT CHECKLIST	43
MASTER BID WORKSHEET	44
TERMS & CONDITIONS WORKSHEET	45
SPECIFICATIONS WORKSHEET	47
NON-COLLUSION AFFIDAVIT	54
CAMPAIGN FINANCE AFFIDAVIT	56
CERTIFICATIONS AGAINST CONFLICTS OF INTEREST, GRATUITIES & KICKBACKS	57

***Attachments must be completed and submitted with Proposal**

SECTION 1. ADVERTISEMENT

CITY OF COVINGTON, KENTUCKY REQUEST FOR PROPOSALS (“RFP”) PURCHASE OF AMBULANCES, FY20

The City of Covington, Kentucky (“City”) invites proposals from qualified, competent, knowledgeable, and experienced providers that provide the goods and services outlined in this Request for Proposals (“RFP”), in compliance with all applicable laws, regulations, and industry standards. Vendors submitting a proposal must be prepared to enter into an agreement (“Agreement”) for the provision of requested goods and services as set forth in this RFP.

RFP TITLE: PURCHASE OF AMBULANCES, FY20

ISSUING ENTITY: CITY OF COVINGTON, KENTUCKY

PUBLICATION DATE: Thursday, August 8th, 2019

DUE DATE AND TIME: Thursday, August 22nd, 2019 at 10:00AM

STAFF CONTACTS:

David Geiger
EMS DIRECTOR
(859) 431-0462
EMSDirector@covingtonky.gov

SUBMISSION LOCATION: Submissions must be received and timestamped by the 1st Floor, Finance Department window prior to the due date and time listed above. Proposal Binders should be submitted in sealed package with following statement:

“PURCHASE OF AMBULANCES, FY20 RFP - DO NOT OPEN WITH REGULAR MAIL”

City of Covington, Kentucky
1st Floor, Finance Department Window
20 W. Pike Street
Covington, Kentucky 41011

REVIEW: Pursuant to KRS 45A.370, the evaluation of Proposals shall be conducted using competitive negotiation. Any final award shall be based upon the criteria set forth below, and shall include the reciprocal preference for residential Respondents outlined in KRS 45A.494, where required. The City finds selection based upon competitive negotiation necessary, upon the determination that ambulances/ EMS vehicles are highly complex pieces of equipment which will require technical discussions as to build, manufacturing process and performance. The Board of Commissioners reserves the right to reject any and all Proposals. All Proposals will be reviewed and scored in accordance with the evaluation criteria set forth herein.

SECTION 2. SCHEDULE

EVENT	DATE
RFP Issuance:	August 8 th , 2019
Deadline for Vendor questions and clarifications:	August 19 th , 2019. Questions and answers to be posted by August 20 th , 2019, via www.covingtonky.gov
Deadline for submissions:	August 22 nd , 2019 at 10:00am, to the City of Covington, 1 st Floor, Finance Department Window, 20 W. Pike Street, Covington KY 41011.
Recommendation for Award to Board of Commission	Anticipated within 30 days of RFP opening.

SECTION 3. INSTRUCTIONS TO RESPONDENTS

3.1 **Purpose and Intent.** This RFP is for two (2) Ambulances, manufactured and delivered in accordance with the terms, conditions, and specifications provided herein. The detailed specifications set forth requirements pertaining to the type of construction, finish, equipment and tests to which the Ambulances shall be manufactured. The intent of this RFP is to procure two (2) Ambulances with the highest level of quality and engineering excellence so as to meet each patient's need for pre-hospital care and to provide a safe working environment for the Emergency Medical Personnel. To this end, the City will evaluate all Proposals submitted against the evaluation criteria set forth in Section 3.6 below.

3.2 **Form of Submission.** Every Proposal must be submitted in a three-ring binder tabbed according to the attachments described below and corresponding to the specifications based upon the way they are sequenced, herein referred to as 'Proposal Binder.' Failure to comply with these submission requirements may result in a Proposal being deemed non-responsive.

3.3 **Respondent Types.** The City is seeking '**Manufacturer Only Respondents**' from this solicitation. For purposes of this solicitation 'Manufacturer Only Respondents' shall mean Respondents who are able to manufacture and deliver the Ambulances in accordance with the specifications stated herein.

3.4 **Exceptions.** These specifications are based upon design and performance criteria which have been developed by the City as a result of extensive research and careful analysis. Subsequently these specifications reflect the only type of Ambulance that is acceptable. Utilizing the **AMBULANCE SPECIFICATION WORKSHEET**, Respondents shall indicate in the "yes/no" column if their Proposal complies on each numbered item specified. If a product brand name is specified and is commercially available to all Respondents, the City requests the use of said brand name. Exceptions and equivalents shall be permitted if they are equal to or superior to the listed specification, see Section 5.21, and provided they are listed and fully explained in an **exception addendum** as described below.

3.5 **Questions and Answers.** Throughout the solicitations process, Respondents may submit clarifying questions related to this RFP to the City's EMS Director, David Geiger via email at EMSDirector@covingtonky.gov or via phone at (859) 431-0462.

3.6 **Evaluation & Award.** A committee of qualified City staff shall evaluate all Proposals from responsible Proposers meeting the mandatory criteria herein to determine, which Proposal is the most advantageous to City based on the following evaluation criteria, and the reciprocal preference for resident bidders required by KRS 45A.494:

Criteria	Weight
Cost. Takes into consideration total per unit cost of the ambulance, including any applicable discounts.	15%

<p>Manufacturing & Financial Capacity. Takes into consideration the Vendor's manufacturing capacity and processes, projected construction schedule, and coordinating delivery date. Also takes into consideration Vendor's financial capacity to fulfill the terms of the contract.</p>	20%
<p>Consistency with the Request. Takes into consideration whether or not Vendor has met or exceeded the requirements of this Request.</p>	20%
<p>Terms & Conditions Provided in Warranty & Legal Documents. Takes into consideration whether or not Vendor has fully accepted all terms and conditions stated herein. Also takes into consideration Vendor provide terms and conditions of the purchase, and how advantageous those terms are to the City.</p>	15%
<p>Proven Performance as Reflected Through Similar Contracts & Letters of Reference. Takes into consideration letters of references, similar contracts, including volume of similar contracts, length of time in business, and industry familiarity.</p>	15%
<p>Service & Support, Including Code of Repairs and Replacement. Takes into consideration customer training and provided materials, ongoing customer support, warranty and repair considerations, and distance to the nearest warranty repair site.</p>	15%
Total	100%

3.8 **Selection Committee.** City staff will establish a selection committee to review and evaluate all submitted Proposals. The selection committee will be comprised of various City staff so as to provide a range of perspectives to contribute to assessing the best value according to the criteria set forth in this RFP.

3.9 **Negotiation.** After identifying a Respondent for Award, the City reserves the right to negotiate fair and reasonable terms and conditions based on the information provided in this RFP and the prevailing Respondent's Proposal. If after negotiation, the parties fail to reach a final agreement, the City reserves the right to proceed to the next highest evaluated proposal, or to reject all proposals.

SECTION 4. PROPOSAL FORMAT AND ATTACHEMENTS

The following section describes the format and the attachments that must be included in the Proposal Binder. All attachments must be submitted in the same order and in a form that is substantially similar to the description provided below. Each Respondent must verify submission of the requested attachments on the **RESPONDENT CHECKLIST**. Respondents should include (3) total Proposal Binders with their submission, one (1) signed original and two (2) copies.

4.1 **Proposal Binder.** Respondent shall prepare a Proposal Binder, tabbed in accordance with the below, which includes all necessary attachment as detailed in this Request:

Tab 1. Respondent Checklist.

Tab 2. Master Bid Worksheet. Terms & Conditions Worksheet.

Tab 3. Specification Worksheet. Exception and Explanatory Addendum.

Tab 4. Statement of Qualifications & Capacity. Similar Contracts. Letters of Reference.

Tab 5. Statement of Financial Capacity.

Tab 6. Profile of Manufacturing Process & Facility.

Tab 7. Service and Support.

Tab 8. Proposed Construction Schedule. Site Visit Costs/ Person.

Tab 9. Description of Training Program & Training Materials. Sample Instruction Manual.

Tab 10. Required Certifications.

Tab 11. Legal Documents.

Tab 12. Invoice, Price Quotes or Work Orders.

Tab 13. Warranties.

4.2 **Respondent Checklist.** Respondent shall complete the 'Respondent Checklist' that is attached to this packet to confirm that it has supplied the requested materials, or, where applicable, that it has not supplied that requested materials. The 'Respondent Checklist' shall be included in the Proposal Binder under **TAB 1**.

4.3 **Master Bid Worksheet.** Respondent shall complete the 'Master Bid Worksheet' attached to this packet. For any alternate pricing proposals such as bulk discounts or discounts for tying together multiple vehicles, Respondents must complete additional 'Master Bid Worksheets.' The completed 'Master Bid Worksheet(s)' shall be included in the Proposal Binder under **TAB 2**.

4.4 **Terms & Conditions Worksheet.** Respondent shall complete the 'Terms and Conditions Worksheet,' confirming its acceptance of the terms listed in *Section 5* of this RFP, or stating its

express rejection, and possible qualified substitution, of said terms. The completed 'Terms and Conditions Worksheet' shall be included in the Proposal Binder under **TAB 2**.

4.5 **Specification Worksheet.** For each Ambulance bid, the Respondent shall complete the corresponding 'Specification Worksheet.' The completed Specification Worksheet and any explanatory addenda shall be included in the Proposal Binder under **TAB 3**.

4.6 **Exception and Explanatory Addenda.**

- a. **Explanatory Addendum.** Where the specifications require an explanation or description of manufacturing techniques, processes or materials, all Respondents shall provide, on separate pages, the requested explanation with the corresponding specification number as a header. The 'Explanatory Addendum' shall be included in the Proposal Binder under **TAB 3** immediately following the **SPECIFICATION WORKSHEET**.
- b. **Exception Addendum.** All exceptions and deviations to specifications shall be explained in a separate addendum. The 'Exception Addendum' shall reference each specification number and provide an explanation for any exception that addresses each of the following issues: (i) how the proposal deviation is different; (ii) how the deviation meets or exceeds the specifications; (iii) and why it is necessary. The 'Exception Addendum' shall be included in the Proposal Binder under **TAB 3**, immediately following the **SPECIFICATION WORKSHEET**.

4.7 **Statement of Qualifications and Capacity.** Respondent shall submit, in no more than three (3) pages, a statement of its qualifications and capacity in relation to its ability to meet or exceed this Request. At a minimum, each Respondent must provide a statement pertaining to the following items to characterize its qualifications and capacity:

- a. A statement of the raw number of modular Ambulance bodies the Respondent has constructed;
- b. A statement that, apart from the chassis, the Manufacturer will manufacture a complete Ambulance, including the modular body and all basic components, entirely within its Manufacturing Facility. For purposes of this section, accessories such as light bars, sirens, etc., shall not be considered basic components of the modular body.
- c. A statement that neither the Respondent, nor its parent company, has have ever been fined or convicted of price fixing, bid rigging, or collusion in any domestic or international Ambulance market.
- d. A statement that neither the Respondent, nor its parent company, has ever had a performance bond called in the last ten (10) years.

The statement of qualifications and capacity shall be included in the Proposal Binder under **TAB 4**.

4.8 **Similar Contracts.** Respondent shall submit a list of at least three (3) similar contracts that it has fulfilled within the last three (3) years. The list shall include (i) the name of the awarding entity, (ii) a contact person and information for the awarding entity, (iii) the specifications of the ambulances manufactured for the awarding entity, and (iv) the timeline from order to completion. The Respondent shall be solely responsible for notifying the contact person at each awarding entity that he or she may be contacted by the City during this process. The 'Similar Contracts' list shall be included in the Proposal Binder under **TAB 4.**

4.9 **Letters of Reference.** Respondent shall submit at least three (3) letters of reference from representatives of awarding entities that Respondent has manufactured ambulances for in the last three (3) years. The letters of reference may correlate with the similar contracts but shall be included separately in the Proposal Binder under **TAB 4.**

4.10 **Statement of Financial Capacity.** Respondent shall submit, in no more than ten (10) pages, a statement of financial capacity, which includes a financial statement setting forth total assets, total liabilities, and bonding capacity. Any Respondent may elect to submit additional documentation to demonstrate its financial strength and project capacity, but must do so in observation of the aforementioned page limit. Materials submitted under this section that Respondent feels may present an unfair advantage to competitors should be marked "**CONFIDENTIAL.**" To the extent permitted by Kentucky Open Records Law, the City will treat such materials as "confidential." The statement of financial capacity and supporting documents shall be in the Proposal Binder under **TAB 5.**

4.11 **Profile of Manufacturing Process and Facility.** Respondent shall submit, in no more than ten (10) pages, a profile of its manufacturing process and facility. This profile shall include the following information:

- a. Employee overview and role designation;
- b. The total square footage of any manufacturing facility;
- c. The Manufacturer's production schedule for the next twelve (12) months;
- d. Any other relevant information that Respondent deems significant to its manufacturing facility and capacity to fulfill this Request.

The profile of manufacturing process and facility shall be included in the Proposal Binder under **TAB 6.**

4.12 **Service and Support.** Respondent shall provide evidence of its ability to render prompt service and support to furnish replacement parts. Such evidence must include substantially all of the following in addition to other information deemed by the Respondent to be significant to this section:

- a. Records and reports of historical service for other Ambulances constructed pursuant to other contracts with relevant metrics such as total downtime per Ambulance, cost of repair, and frequency of repair;
- b. Evidence of partnership, or similar, agreements with Factory Authorized/ Warranty Service Centers;

- c. A list of all Factory Authorized/ Warranty Service Centers with the distance from the City of Covington;
- d. A statement of capacity of any Factory Authorized Service Center, which includes the total number of factory-trained mechanics on staff who are well versed in all aspects of service for all major components of any Ambulance;
- e. An inventory report of any parts repository and its ability to fulfill warranty service requirements and parts requirements for each Ambulance;
- f. All Respondents shall provide a listing of the Vendors, manufacturing location, and engineering source for each individual, major component of the Ambulances.

The evidence related to service and support shall be included in the Proposal Binder under **TAB 7**.

4.13 Proposed Construction Schedule. Respondent should provide a proposed construction schedule and delivery date. The construction schedule should include all proposed meetings, including pre-construction, mid-construction, and final construction and any other milestones that Respondent deems relevant. The proposed construction schedule shall be included in the Proposal Binder under **TAB 8**.

4.14 Site Visit Costs Per Person. Respondent should provide an attachment for the per person cost to attend construction meetings throughout the manufacturing process. Site visit costs should include a detailed breakdown of all included expenses (i.e. meals, travel, lodging, etc.). The per person site visit cost shall be included in the Proposal Binder under **TAB 8**.

4.15 Description of Training Program and Training Materials. Each Respondent shall submit a description of its training program. The description must not exceed three (3) pages. Each Respondent may also submit any sample materials that it has utilized on a previous project for a similar ambulance. The training description and sample training materials shall be included in the Proposal Binder under **TAB 9**.

4.16 Sample Instruction Manual. Respondent shall submit with its Proposal a sample instruction manual, preferably from a previous project. Preference will be given to Respondents that can demonstrate their capacity to produce an instruction manual that is digital in form. The sample instruction manual shall be included in the Proposal Binder under **TAB 9**.

4.17 Required Certifications. Respondent shall submit with its Proposal proof of all 'Required Certifications.' Such 'Required Certifications' shall include the following:

- a. A letter from the National Truck Equipment Association (N.T.E.A.) that Respondent is a member in good standing with the Ambulance Manufacturer's Division.
- b. A copy of Respondent's approved certification testing from MME or other qualified testing facility shall be included with the bid.
- c. Documentation verifying that all CAAS-GVS testing is current and certified by an independent Engineering firm.

d. Documentation verifying that Respondent is an approved Ford vehicle modifier.

Respondent may include any additional certifications they deem significant to this section. All required certifications shall be included in the Proposal Binder under **TAB 10**.

4.18 **Legal Documents**. Respondent must attach any legal documents that it seeks to have incorporated into any final agreement. Any applicable documents shall comply with all terms and conditions outlined throughout this solicitation, and shall not disclaim any Respondent liabilities or warranties. Legal documents should include any 'Manufacturer's Quality Assurance Vehicle Testing' documentation, standard terms and conditions, and any acceptance documents. Additionally, Respondent must complete and include the following affidavits and certifications:

- a. **Non-Collusion Affidavit**. Respondent must complete and include in the Proposal Binder the 'Non-Collusion Affidavit' located at the end of this RFP.
- b. **Campaign Finance Affidavit**. Respondent must complete and include in the Proposal Binder the 'Campaign Finance Affidavit' located at the end of this RFP.
- c. **Certification against Conflicts of Interest, Gratuities, and Kickbacks**. Respondent must complete and include in the Proposal Binder the 'Certification Against Conflicts of Interest, Gratuities, and Kickbacks,' located at the end of this RFP. This certification asserts the Respondents adherence and understanding to KRS 45A.455.
- d. **Bid Bond**. Respondent shall provide a bid bond as security for the bid in the form of a ten percent (10%) bid bond to accompany their bid. This bid bond shall be issued by a surety company who is listed on the U.S. Treasury Departments list of acceptable sureties as published in Department Circular 570. The bid bond shall be issued by an authorized representative of the surety company and shall be accompanied by a certified power of attorney dated on or before the date of bid. The bid bond shall include language, which assures that the Respondent/principal shall give a bond or bonds, as may be specified in the bidding or contract documents, with good and sufficient surety for the faithful performance of the contract, including the basic one (1) year limited warranty, and for the prompt payment of labor and material furnished in the prosecution of the contract. Respondents who do not manufacture the chassis shall provide a 3 year/ 36,000 mile warranty that shall be issued jointly and severally by, and signed by, both the Respondent and the chassis manufacturer. Upon an Award of Contract, the City shall require a performance & payment bond from Respondent for the full value of the contract. The bid bond shall be included in the Proposal Binder under TAB 14.
- e. **Insurance documentation**. Respondent must include with their submitted Proposal proof of adequate insurance coverage, as defined by Section 5.15 of this RFP. Respondent should submit a certificate of insurance (COI) for all required coverages. The COI shall contain the coverage schedule, explaining the type of insurance, the policy number, the effective date of coverage, the policy expiration date, and the individual limits of liability. The COI shall show the City as a certificate holder.

The legal documents shall be included in the Proposal Binder under **TAB 11**.

4.19 **Invoice, Price Quote or Work Order.** Respondent shall supply a sample invoice, price quote, or work order for each ambulance that it proposes to manufacture. The document shall include all fees, charges, delivery costs, pre-payment options, and available discounts. The Respondent may set forth various pricing options on several separate sheets. Any applicable purchase order/price quote shall comply with all terms and conditions outlined throughout this solicitation, and shall not disclaim any Respondent liabilities or warranties. The invoice or price quotes shall be included in the Proposal Binder under **TAB 12**.

4.20 **Warranties.** Each Respondent shall provide copies of the following warranties:

- a. Lifetime Structural Module Warranty;
- b. Four (4) year/48,000 mile Limited Ambulance conversion warranty;
- c. Lifetime Electrical Warranty for electrical system provided by ambulance manufacturer
- d. Seven (7) year Paint warranty to include coverage for paint defects due to corrosion and dissimilar metals.

All warranties shall be included in the Proposal Binder under **TAB 13**.

SECTION 5. TERMS AND CONDITIONS

5.1 **Respondent's Warranties and Representations.** Upon execution of a final agreement, all documents that Respondent has submitted in response to this Request, shall be incorporated into as warranties and representations, which shall survive the completion of the project.

5.2 **Accuracy of Images.** Images and illustrative material in this specification are as accurate as known at the time of publication, but are subject to change. Images and illustrative material are for reference only.

5.3 **Inspections.** The Awardee shall permit City staff, or any City designee, to inspect the Ambulance(s) during manufacturing on no less than two (2) occasions, the terms of which shall be determined between the parties prior to executing a final agreement. The City may elect, in lieu of a mid-line inspection, to receive digital pictures sent by e-mail to an address designated in the pre-construction conference. Pictures shall include, but not limited to, cab interior and exterior, module interior and exterior and compartment interiors.

5.4 **Pre-Construction Meeting(s).** Pre- construction meeting(s) shall be held prior to the commencement of any work being done on any ambulance. Authorized representatives from both the City and prevailing Respondent shall participate, as needed, to ensure that the ambulance fulfills all requested specifications. Authorized representatives from both the City and prevailing Respondent shall approve and sign any changes made during these meetings prior to the commencement of any work being done. At the pre-construction meeting Respondent shall ensure a certified engineer shall be present for the duration of each engineering section.

5.5 **Training.** The prevailing Respondent shall provide all relevant City personnel with training on the ambulances as a condition of acceptance. Said training sessions shall be conducted at the sole expense of the prevailing Respondent.

5.6 **Term of Offer.** Submitted Proposals shall remain open, as valid and qualified offers to the City, for one hundred and eighty (180) days from the close of the solicitation.

5.7 **Payment.** Final payment terms for the ambulance(s) shall be subject to the terms and conditions of the final agreement with the City. Unless otherwise provided in the terms of a final agreement, final payment will be made no sooner than thirty (30) days after acceptance of the ambulance(s).

5.8 **Contractor Deliveries.** According to the timelines provided below, and prior to acceptance, the Respondent shall provide the following to the City:

- a. Two (2) copies of conversion parts, service, and operational manuals in electronic .PDF file format on a USB Flash drive.
- b. Two (2) OEM Chassis Owner's Guide materials as provided by the chassis manufacturer.
- c. Two (2) copies of "as built" customized electrical schematics on ambulance conversion on a USB Flash drive.

- d. A CAAS-GVS certification sticker, electrical load analysis sticker, and payload sticker shall be installed in the Oxygen Compartment.

5.9 **Required Tests.** In addition to all tests required under the specifications below, the following tests shall be conducted upon each Ambulance at the relevant times in the manufacturing process:

- a. **A.M.D. 001 - MANUFACTURERS' BODY STRUCTURE TESTING:**
The ambulance described herein shall be tested to the National Truck Equipment Associations Ambulance Division, Standard 001 – Static Load Test except the test weight shall be at least 2.5 times the test weight imposed by A.M.D. 001.
- b. The manufacturer shall inspect and test all systems, electrical loads, and conduct all other required tests per the specification CAAS-GVS standards in effect at time of manufacture. Testing results shall be documented and displayed in the oxygen compartment and/or supplied with the vehicle delivery handbook.

5.10 **Failed Tests.** In the event any ambulance fails a required test, a second test may be conducted within thirty (30) days to establish that the Ambulance meets the required specifications. The continued failure of any Ambulance to pass a required test shall give the City the right to terminate the final agreement. An independent testing laboratory shall certify all required test results. The certified test results will be supplied to the City upon request.

5.11 **Acceptance.** The City shall not be deemed to have accepted any ambulance constructed until (i) all deliveries are made; (ii) the Ambulance(s) have passed all required tests; (iii) and the City, or its designees, have had a commercially reasonable time during which to confirm that the Ambulance was constructed according to the specifications. Upon discovery that such criteria are not fulfilled, the City may reject said Ambulance at the sole cost of the Manufacturer. The storage of any Ambulance in a City facility shall not be deemed acceptance by the City.

5.12 **Delivery.** Delivery of any ambulance shall be made according to the timelines negotiated by the parties and incorporated into any final agreement. Should there be a delay in delivery the awarded Respondent shall be subjected to liquidated damages in an amount equal to \$200,000/day of delay, or an amount agreed upon by the parties and incorporated into a final agreement. The terms of any final agreement shall provide that each ambulance shall be delivered to the City's designated location with approximately a full tank of fuel. In order to ensure proper break in of all components while still under warranty, each ambulance shall be delivered under its own power - rail or truck freight shall not be acceptable. A qualified delivery representative shall deliver the ambulance and remain for a sufficient length of time to instruct personnel in proper operation, care and maintenance of the equipment delivered. Delivery to Covington's facilities shall not be deemed acceptance.

5.13 **Indemnification.** The prevailing Respondent shall indemnify the City against any damages to property or injuries to or death of any person or persons, including property and employees or agents of the City, and shall defend and indemnify the City from any claims, demands, suits, actions or proceedings of any kind, including workers' compensation claims, of or by anyone, in any way resulting from or arising out of the Work, including operations of subcontractors and acts or omissions of employees or agents of the Contractor or Subcontractors. Insurance coverage specified in this RFP, and in the special conditions, constitutes the minimum requirements and those requirements shall in no way lessen or limit the liability of the Contractor under the terms of the contract.

5.14 **Duty to Defend.** In addition to the indemnity provided above, the prevailing Respondent shall defend any and all suits and assume all liability for the use of any patented process. Including any device or article forming a part of the ambulance, or any appliance furnished under the contract.

5.15 **Insurance.** Respondent shall be obligated to carry the following minimum insurance coverages:

- a. **General Liability Insurance.** The Prevailing Respondent shall, during the performance of the contract, keep in force at least the following minimum limits of commercial general liability insurance:
 - a. Each Accident Combined Single Limit: \$3,000,000
 - b. Each Occurrence: \$3,000,000
 - c. Products/Completed Operations Aggregate: \$5,000,000
 - d. General Aggregate: \$5,000,000

Coverage shall be written on a Commercial/ General Liability form. The policy shall be written on an occurrence form and shall include Contractual Liability coverage for bodily injury and property damage subject to the terms and conditions of the policy. The policy shall include the City as an additional insured when required by written contract.

- b. **Umbrella/ Excess Liability Insurance.** The Prevailing Respondent shall, during the performance of the contract, keep in force at least the following minimum limits of umbrella liability insurance:
 - a. Aggregate: \$25,000,000
 - b. Each Occurrence: \$25,000,000

The umbrella policy shall be written on an occurrence basis and at a minimum provide excess to the Respondent's General Liability, Automobile Liability and Employer's Liability policies. The required limits can be provided by one (1) or more policies provided all other insurance requirements are met. Coverage shall be provided by a carrier(s) rated A- or better by A.M. Bests.

All policies shall provide a thirty (30) days' notice of cancellation to the named insured and any certificate holders. Respondent agrees to furnish the City with a current 'Certificate of Insurance' (COI) with the coverages listed above along with its submitted Proposal. The COI shall contain the coverage schedule, explaining the type of insurance, the policy number, the effective date of coverage, the policy expiration date, and the individual limits of liability. The COI shall show the City as a certificate holder.

5.16 Approval Drawing. A drawing of the proposed Ambulance shall be provided to the City for approval prior to any construction. The sales representative shall also have a copy of the same drawing. The finalized and approved drawing shall become part of the contract documents. This drawing shall indicate the chassis make and model, location of the lights, siren, horns, compartments, major components, etc. If applicable, a "revised" approval drawing of the ambulance shall be prepared and submitted to the City showing any changes made to the original approval drawing.

5.17 Quality of Materials. The emergency medical care vehicle, chassis, ambulance body, equipment, devices, medical accessories and electronic equipment to be delivered under this contract shall be standard commercial products, which meet or exceed the requirements of the issued specifications. The ambulance shall comply with all Federal Motor Vehicle Safety Standards (FMVSS), and the Federal regulations applicable or specified for the year of manufacture. The chassis, components and optional items shall be as represented in the manufacturer's current technical data. Materials used in the construction shall be new and not less than the quality conforming to current engineering and manufacturing practices. Materials shall be free of defects and suitable for service intended. The ambulance and the allied equipment furnished under this specification shall be the manufacturer's current commercial vehicle of the type and class specified. The ambulance shall be complete with the operating accessories as specified herein. Items will be furnished with such modifications and attachments as may be necessary and specified to enable the vehicle to function reliably and efficiently in sustained operation. The design of the vehicle and the specified equipment shall permit accessibility for servicing, replacement and adjustment of component parts and accessories with minimum disturbance to other components and systems. The term "heavy-duty" as used to describe an item, shall mean in excess of the usual quality or capacity that is normally supplied with the standard production vehicle or component.

5.18 Revisions. If it becomes necessary to revise any part of this Request, a written addendum will be made publicly available via publication on the City's website, www.covingtonky.gov. The City is not bound by any oral representations, clarifications, or changes made by any City employee, unless such clarification or change is publicly issued to the City's website, in written addendum, from an authorized representative of the City. It shall be the obligation of the Respondent to reference the City's website throughout the solicitation process and prior to its submission of a Proposal, to ensure awareness of any issued addenda.

5.19 Modifications to Specifications. Images and illustrative material in the specifications are as accurate as known at the time of publication, but may be subject to change.

5.19 **Minor Modifications.** Minor details of construction and materials, which are not otherwise specified, are left to the discretion of the Prevailing Respondent.

5.20 **Interpretation of Specifications.** If any Respondent finds a conflict between the City's specifications and compliance with CAAS-GVS or Commonwealth of Kentucky KAR and KRS regulations, it shall be the Respondent's obligation to notify the City in a timely manner.

5.21 **Items Considered Equal.** In accordance with KRS 45A.415, items considered equal to those named or described in the specifications may be furnished. Except where an item is brand specific and listed as **NO EXCEPTIONS**. Where a brand specific item is listed with **NO EXCEPTIONS**, that item has been identified as specifically necessary to the compatibility, continuity, or conformity with the City's pre-existing Ambulance/ EMS standards.

An item shall be considered equal to the item named or described if:

- a. It is at least equal in quality, durability, strength, design, and other criteria deemed appropriate;
- b. It will perform at least equally the function imposed by the general design for the public work being contracted for or the material being purchased; and
- c. It conforms substantially to the detailed requirements for the item in the specifications.

SECTION 6. AMBULANCE SPECIFICATIONS

6.1 CHASSIS – Ford F-450 Super Duty COMMERCIAL CHASSIS, 189" WB, 4 X 4 DWD – Diesel. Model year 2020 or newer Ford F-450 Super Duty 4x4 Commercial Chassis with a wheelbase of not less than 189", Dual Rear Wheels (108" C.A.). All Respondents must state in their respective proposals the total available payload of the completed ambulance. **NO EXCEPTIONS.**

6.2 AMBULANCE PREP PACKAGE. Chassis shall be provided with OEM Ambulance Prep Package and Compliance Stickers. All items normally provided in the OEM Ambulance Prep Package will be included even if not otherwise specifically mentioned in this document.

6.3 AIR BAGS – DUAL. The Ford OEM chassis shall have driver and passenger side air bags. The air bags shall be newest generation.

6.4 AIR CONDITIONING. The chassis shall be equipped an OEM high output fresh air heater and air conditioner system.

6.5 BATTERIES Respondent shall provide details for their standard battery installation, minimum two (2), including number, type, and CCA ratings of batteries to be installed.

6.6 DUAL ALTERNATORS - 357 AMPS. Chassis shall have dual OEM Ford alternators with internal regulators and rectifiers rated at a combined 357 amps.

6.7 BRAKES - 4 WHEEL ABS DISC. The OEM Ford chassis shall have Heavy-Duty, dual hydraulic / hydroboost brake booster, power disc-type brakes on the front and rear axles. An all-wheel "Front and Rear axles" Anti-lock brake system (Four-Wheel ABS), and dual diaphragm booster with parking brake cable to rear wheels.

a. **BRAKES – TELMA AUXILIARY RETARDER SYSTEM.** The vehicle shall be fitted with a TELMA Magnetic driveline retarder auxiliary braking system. **NO EXCEPTIONS.**

6.8 ENGINE - FORD – 6.7-LITER POWERSTROKE V8 TURBO DIESEL Chassis shall be equipped with a 6.7-Liter Direct Injected Turbo Diesel V-8 Engine which includes: Block Heater, Coolant Recovery System, Engine Oil Cooler Integral with Engine, Heavy-Duty Cooling System and Catalytic Converter. The Engine shall be rated at 300H.P. @2800RPM and 660lb.-ft. @1600R.P.M. **If a long idle shutdown feature is supplied by the chassis manufacturer it shall be deactivated unless the vehicle engine is programmed to automatically restart when the driver steps on the brake pedal.**

6.9 GLASS, WINDOWS – TINTED. All window glass on the chassis cab shall be tinted at 30%

6.10 HORNS – ELECTRIC. Chassis shall have OEM electric horns activated on the steering wheel.

6.11 LIGHTS, CHASSIS EXTERIOR. Chassis shall have standard OEM exterior lights: Two (2) Dual-beam jewel-effect headlamps, intelligent 3-blink turn signals, roof clearance marker lights and a heavy-duty turn signal flasher.

6.12 LIGHT, CAB DOME. Chassis shall have a cab door activated courtesy light consisting of dual adjustable map/reading lights.

6.13 MIRROR, FLAT DAY/NIGHT - CAB INTERIOR. A minimum of a color 4.3" LCD/ LED screen and auxiliary video inputs shall completely replaces the OEM mirror while giving you the convenience of a 4.3" LCD screen and a video inputs. See 6.168 for more detail.

6.14 POWER WINDOWS / DOOR LOCKS. Chassis shall have OEM power windows and door locks.

6.15 SEATS - HIGH BACK CAPTAIN - INBOARD ARM RESTS. Chassis shall have two (2) deluxe reclining high back captain's chairs provided by the OEM chassis manufacturer. Both seats shall be adjustable and have retractable combination shoulder harness / lap straps. The shoulder harness D-rings shall be adjustable. Both seats shall have inboard armrests only.

6.16 40 GAL. FUEL TANK . FORD F-450 Chassis shall have a single tank with total capacity of not less than 40 Gallons and auxiliary fuel port.

6.17 AXLE RATING, FRONT - 4,600 LBS. The front axle rating on the F-450 chassis shall be 4,600 Lbs. rating (4,600 Lbs. G.A.W.R.).

6.18 AXLE RATING, REAR - 9,600 LBS. The F-450 Dual rear wheel axle rating shall be 9,600 Lbs. (9,600 Lbs. G.A.W.R.). The rear axle ratio shall be 4.10 with locking differential.

6.19 Suspension, FRONT - 4,600 LBS. The front spring rating of the F-450 chassis shall be 4,600 Lbs. Combination rated, coil type.

6.20 Suspension, REAR – Liquid Spring. A CLASS®, or Compressible Liquid Adaptive Suspension System, shall be provided and installed. Utilizing a strut, with a compressible fluid as the spring/damping medium, and its sophisticated on-board microprocessor, CLASS® adapts the entire vehicle's response to road variations and the driver. The system shall include an automatic lowering feature, which is activated by opening the side module entry door or the rear patient compartment doors. There shall be a switch near the rear doors, which will defeat the lowering feature. **NO EXCEPTIONS.**

6.21 G.V.W.R. - 16,000 LBS. Ford F-450 Dual rear wheel chassis shall be rated at not less than 16,000 Lbs. G.V.W.R.

6.22 SHOCK ABSORBERS. Chassis shall have Front Heavy Duty shock absorbers– piston type, gas pressurized.

6.23 STEERING, POWER ASSIST, TILT WHEEL. Chassis shall have power assist steering, with a tilt steering wheel.

6.24 TIRES - 225/70R X 19.5G ALL SEASON. Vehicle shall have six (6) 225/70R X 19.5 (10-Ply rated), Steel belted Radial, All-Season tires.

6.25 TIRE, SPARE. Respondent shall indicate cost savings to delete spare tire/rim and tire changing tools.

6.26 TRIM INTERIOR – FORD XLT CHASSIS OEM. Shall have Steel HD Vinyl cab interior color. Shall have a molded OEM cab headliner. Shall have OEM color coordinated cab door trim panes with storage pockets. Arm rests, sun visors and dash shall be padded. Interior shall have OEM heavy-duty molded plastic stepwell pads. Shall have cab floor coverings as provided by chassis manufacturer with standard trim package.

6.27 CUP HOLDERS. Cab interior shall provide two (2) cup holders.

6.28 AM/FM/ RADIO. Vehicle shall be supplied with OEM Radio that is indicated in Ambulance Prep Package and/or proposed trim package but shall not be less than an AM/FM radio.

6.29 STABILIZER BARS, FRONT & REAR. Shall have Heavy Duty OEM stabilizer bars on the front and rear.

6.30 TRANSMISSION- AUTOMATIC-6 SPEED AUTOMATIC. The chassis shall have an automatic 6-speed, Heavy Duty Transmission.

6.31 TRANSMISSION OIL COOLER An OEM factory installed auxiliary, external transmission fluid cooler shall be installed in front of the radiator.

6.32 WIPERS -2 SPEEDS – INTERMITTENT. Two (2), two-speed electric wipers with washers, and intermittent operation feature shall be included on the chassis.

6.33 HEAT SHIELDS. Protective heat shields shall be installed above the exhaust system as recommended by the chassis manufacturer.

6.34 RUNNING BOARDS WITH GRIP STRUT. Flared aluminum diamond plate running boards with Grip Strut, or comparable alternative, shall be provided on the cab. The running boards shall be wider toward the rear, extending out to the corners of the module, and shall be anodized after they are formed to retain finish and increase corrosion resistance.

6.35 BACKUP ALARM. A Back-Up Alarm (OSHA Approved) minimum of 97 decibels at 4 feet will be installed and shall automatically activate whenever vehicle is placed in 'reverse' gear.

6.36 ENGINE BLOCK HEATER - SHORE LINE SUPPLIED & SWITCHED. The engine block heater shall be electrically tied to the unit shoreline. There shall be a summer/winter switch consisting of a 15 Amp (toggle) circuit breaker, located in the PDQ (Power Distribution Quarters) to disable the block heater in warm weather conditions.

6.37 MIRRORS, EXTERIOR FORD OEM TELESCOPING-POWER WITH/CONVEX. Chassis shall have heated OEM mirrors with power adjusted flat glass and manual adjusted convex glass.

6.38 FLOOR CONSOLE, MAP STORAGE. A center floor console with a recessed storage well and an attached map storage area shall be included in the cab, between the seats. The console shall be able to house communications radios as well as any lighting system and siren control heads as specified herein.

6.39 MAP LIGHT. A flexible goose-neck map light with red or white light capabilities shall be installed on the Floor Console in close proximity to the passenger seat.

6.40 ELECTRICAL CIRCUITS 12 VOLT. All electrical circuits shall have wiring and circuit protection suitable to the demand and must meet the National Electrical Wiring Code requirements.

- a. The entire 12 Volt electrical system shall comply with the recommended standards and practices per FMVSS Specifications, CAAS-GVS & SAE where applicable.
- b. All added on wiring (18GA through 10GA) shall be color-coded and heat stamped with code numbers and functions every 4" for easy identification (all other wiring shall be color coded).
- c. SGX insulated cable shall be used for all underhood / underbody battery and charging system cable. SXL high temperature thermoplastic cross link wire shall be used. High temperature (375°F) thermoplastic loom shall be used on all harnesses.
- d. Electrical system shall consist of Five (5) main wiring harnesses that terminate at the electrical distribution panel. Distribution panel shall be centrally located with connections resulting through 45 Pin connectors. Harnesses shall include One (1) for Left Body, One (1) for Right Body, One (1) for Life Support Station, One (1) for Cab Switch Console and One (1) for Chassis.
- e. All electrical components shall be mounted using "Plug In" type assembly, which affords speedy replacement of failed components. The entire unit shall be housed in a readily accessible maintenance cabinet. Attached to inside of door shall be complete documentation of the 12 Volt Electrical system. The use of an exterior mounted electrical distribution panel is unacceptable.
- f. The Main Power Distribution Panel shall consist of a Plug-In Modular system that includes locations for Forty Two (42) Plug-In circuit breakers and Sixty (60) Plug- In Relays, as standard equipment. This type of system is utilized to have standard circuit configuration while remaining totally flexible for custom circuits when required. All circuits shall consist of Plug-In Relays and Plug-In Circuit Breakers only. The use of Diodes, Rectifiers, Heat Sinks, or other than automotive type relays is unacceptable.

6.41 CIRCUIT BREAKERS. All circuit breakers thirty (30) Amps or less shall be plug-in manual and/or auto reset type. All circuits that require greater capacity shall utilize a Cooper Electric or equal forty (40) or fifty (50) amp "Maxi-Amp" manual or auto reset circuit breaker, dependent on electrical application.

6.42 RELAYS. Devices being switched with loads in excess of One (1) Amp (12 Watt) shall be accomplished through Potter & Brumfield or equal, Forty (40) Amp SPDT 12 Volt automotive relay switching devices. All relays used in the panel shall be of the same type to insure complete compatibility and ease of replacement. Relays shall be controlled through a ground signal from all switches, including doorpost switches. All relays shall be plugged into the modular panel assembly including the 70 Amp Power relays where required. All relay circuits utilizing the SPDT relays and SPST 70 Amp relay shall include internal suppression to eliminate voltage spikes in the electrical system.

6.43 GROUNDING. All modular bodies shall be grounded to the vehicle chassis via Two (2) 000 GA braided tinned copper grounding straps. Stranded copper conductors, such as battery cables, shall not be used. Each appliance (i.e. lights, fans, etc.) shall be grounded to the body structure in close proximity to its location or by a ground harness as required. The ground shall be equivalent to its feed wire size and be minimized in length. Each ground attached directly to the vehicle structure shall use machine screws with star washers or ring terminals with serrated ring to ensure a positive contact at all times. All body harnesses shall be contained within the body. Harnesses shall not be run on the underside exterior of the body. Under hood harnesses shall be protected within high temperature convoluted loom. All connections exposed to the elements or under hood shall be made within "waterproof" heat shrink connections. This type of connection shall also be used on all heavy-duty battery cables. All battery cables, both positive and ground shall be machine crimped and fully soldered prior to addition of waterproof heat shrink tubing. Any exposed connections not in heat shrink and battery connections not soldered shall be rejected. All electrical systems shall include Three (3) spare relays and spares of the correct size circuit breakers utilized, shall be mounted within the Electrical Distribution Panel.

6.44 12V – 110 VOLT CIRCUIT SCHEMATIC DOCUMENTATION. All harnesses, relays, circuit breaker terminal junction points and circuits shall be drawn on individual 8 ½ X 11 size drawings. Each individual circuit shall be on One (1) drawing for ease of troubleshooting. A single drawing overall schematic is unacceptable. All electrical systems shall be designed for each vehicle. Generic or similar drawings are cause for rejection of vehicle. All schematics shall include only what circuits are provided in the proposed vehicle.

6.45 ELECTRICAL ANALYSIS. Proper balance of the electrical system output and vehicle draw is critical in the design of all emergency vehicles. Vehicle proposed shall be provided with a detailed electrical analysis generated by the manufacturer of the ambulance and specific to this proposed vehicle and specific electrical equipment requested. General statements will not be acceptable.

6.46 DOOR POST SWITCHES ENTRANCE AND COMPARTMENT DOORS. Sealed doorpost switches shall be installed in all entrance and compartment doors. All switches shall be sealed from the elements to prevent moisture damage and to prolong service life. The switches shall be warranted for the life of the vehicle. All doorpost switches shall activate the grounds of relays only. Under no circumstance shall the doorpost switch carry more than 140 Milliamps of electrical current.

6.47 WARNING DISPLAY. A warning display shall be installed in the cab to provide visual and audible indications for:

- a. Parking Brake Set Condition
- b. Parking Brake Release Condition
- c. Outside Storage Compartment "DOOR OPEN" Warnings
- d. Low Voltage
- e. Low Oxygen Pressure Alarm

6.48 MASTER CONTROL CONSOLE. Respondent shall supply detailed explanation of their construction techniques for a Master Control Console, mounted in the cab. The console will be easily removed for servicing of electrical components without hindering the removal of the engine cover.

6.49 ELECTRICAL COMPARTMENT. The Electrical Compartment shall hold electrical components, (i.e., relays, circuit breakers, etc.) The Electrical Compartment shall be enclosed with a lockable, hinged door. One (1) spare 15 Amp circuit shall also be provided. All wiring harnesses shall be connected via a quick connect circular plug connectors. Communication radio tie-in points shall be installed and labeled in the cab console. The radio tie-in points shall be comprised of insulation terminal stud blocks with one battery "HOT" and one ignition activated "HOT".

6.50 EMERGENCY MASTER SWITCH. An Emergency Master switch for activating all emergency lights and the Load Management system shall be provided on the Master Control Console.

6.51 CONTROL PANEL SWITCH ILLUMINATION. The switches on the Master Control Console and Attendant Control Panel shall have illumination for easy functional identification, day or night.

6.52 MODULE POWER SWITCH. A Module Power switch for all the add-on electrical equipment shall be provided on the master control console.

6.53 AMP/VOLTMETER. Ammeter(s) and Voltmeter(s) shall be provided on the Master Control Console.

6.54 PARK OVERRIDE. A "PARK OVERRIDE" switch, located on the Master Control Console shall reactivate all lights disabled when the transmission is placed in the Neutral/Park positions.

6.55 LOAD MANAGER. A Load Manager shall be installed. The Load Manager will automatically shed lights to help prevent electrical system overload, when the vehicle is stationary and the transmission is in the "PARK" position.

6.56 WARNING LIGHTS SWITCH. All flashing module warning lights shall be operated from a switch(s) on the Master Control Console as specified throughout this document.

6.57 FRONT CLEAR DISABLE SWITCH. Activation of the “FRONT CLEAR DISABLE” Switch on the Master Control Console shall disable all forward-facing clear warning lights.

6.58 CURBSIDE SCENE LIGHTS "ON" WITH CURBSIDE DOOR. The curbside scene lights shall be wired to activate when the curbside door is in the open position.

6.59 REAR SCENE LIGHTS "ON" WITH REAR DOORS OPEN. The rear scene lights shall be wired to activate when the rear doors are in the open position.

6.60 SHORELINE INLET RECEPTACLE, HEAVY-DUTY, 20 AMP AUTO EJECT. A Kussmaul “Super Auto-Eject” SHORELINE Male Motor Base Model 091-55-20-120 with RED cover shall be installed and labeled on the module exterior (forward street side) near the driver’s door and have a power indicator light mounted above it. The 115VAC, Heavy Duty 20-Amp receptacle shall have circuit interrupt, connected to the lighted Patient Care Area outlets and to the engine block heater (with a block heater “Summer/Winter” switch in the Power Distribution Quarters.) A Matching Female Connector designed for use with the auto-eject shoreline shall be shipped loose with the vehicle.

6.61 SHORELINE INLET RECEPTACLE, HEAVY DUTY, 30 AMP AUTO EJECT. A Kussmaul Auto Eject shoreline inlet receptacle with a RED cover shall be installed and labeled on the module exterior near the driver’s door and have a power indicator light shall supply power automatically to the auxiliary AC/Heat climate control system. A Matching Female Connector designed for use with the auto-eject shoreline shall be shipped loose with the vehicle.

6.62 GROUND FAULT CIRCUIT INTERRUPTER (GFCI). A 20 Amp Duplex receptacle with ground fault circuit interrupter (GFCI) electronic ground leakage detector shall be installed in the electrical distribution compartment for the shoreline circuit.

6.63 ENGINE HOUR METER. An Engine hour meter shall be provided and installed in the Master Control Console.

6.64 INVERTER/BATTERY CHARGER. The vehicle shall have a *VANNER* LifeStar model 20-1050CUL-DC Ambulance Power Module installed. Inverter shall automatically take- over providing power to all 115v AC outlets from the shoreline when vehicle is started.

MODULE SPECIFICATIONS

6.65 MODULE BODY CONSTRUCTION. Respondent shall supply detailed explanation of their construction techniques for fabricating an all aluminum module body, including material thicknesses and alloy types.

6.66 CONNECTIONS, CAB TO MODULE. Respondent shall supply detailed explanation of their construction techniques for joining the module to the cab.

6.67 CONNECTIONS, MODULE TO FRAME RAILS. Respondent shall supply detailed explanation of their construction techniques for connecting the module body to the chassis frame rail.

6.68 ALUMINUM PARTS, MODULE EXTERIOR. All unfinished exterior aluminum parts shall be anodized after fabrication to retain the finish and increase corrosion resistance.

6.69 DOOR CONSTRUCTION - GASKET PLACEMENT. Respondent shall supply detailed explanation of their construction techniques for all exterior hinged module doors, including material thicknesses and alloys used. Door gaskets shall be attached to the interior side of the door skin. Gaskets attached to interior door frames are not satisfactory and will not be accepted.

6.70 SWEEP-OUT COMPARTMENTS. Exterior module compartments shall be of a sweep-out design to aid in facilitation of the purchaser's routine care and cleaning of the unit. All exterior compartment floors, with the exception of the front ALS compartment shall be constructed to be flush with the bottom of the doorframe.

6.71 INSULATION. All insulation products used shall comply with FMVSS #302 Flame spread requirements. The entire underside of the module body, including all frame members, compartment lower panels and sub-floor shall be properly prepared and treated with a high quality automotive type, spray on undercoating.

6.72 FLOOR CONSTRUCTION- PATIENT COMPARTMENT. Respondent shall supply detailed explanation of their construction techniques for the sub-floor in the Patient Care Compartment. The floor shall be sealed to prevent fluids from seeping under the cabinets.

6.73 MUD FLAPS, REAR. Black rubber-reinforced mud flaps, 1/4-Inch thickness, 24 Inches x 20 Inches shall be bolted to the underside of the module behind the rear wheels.

6.74 RUB RAILS, BLACK RUBBER. Black rubber rub rails shall be installed on the lower sides of the body below the outside compartment sill areas.

6.75 FENDERETTES, BLACK RUBBER. Black rubber fenderettes shall be installed around the rear wheel well openings.

6.76 STONE GUARDS, MODULE FRONT - DIAMOND PLATE. Anodized aluminum diamond plate stone guards shall be installed on the lower 24 Inches of the module front.

6.77 THRESHOLD, CURBSIDE DOORWAY. A stepwell liner shall be installed in the curbside doorway threshold.

6.78 THRESHOLD, REAR DOORWAY. An anodized aluminum diamond plate threshold shall be installed at the rear doorway, providing a kick / scuff plate at the rear of the vehicle.

6.79 ANTI-CORROSION PROTECTION-MODULE. All module contact with dissimilar metals shall be protected with the use of nylon screw-hole inserts to prevent fastener contact with the module body, nylon hinge strips, ceramic-coated hinge bolts, and corrosion prohibitor spray.

6.80 DOORS, ALL – CAB & MODULE – ‘STRAPPED.’ All doors on the cab and the module shall be ‘Strapped’ to prevent hinge damage from over extension. ‘Strapping’ involves the installation of webbing of sufficient width, thickness and quantity so as to absorb the force overextension would otherwise place on the door hinges. Rear patient compartment entry doors and sliding doors, if equipped, are exempt from this requirement.

6.81 DOORS, MODULE CURBSIDE PASSAGE. Respondent shall supply detailed explanation of their construction techniques for the curbside module door, including material thicknesses and alloys used, latching and locking devices, etc. The doors shall be lockable from the inside and outside. All doors shall shut on molded, air-core, automotive type door seals to prevent any water from leaking into the vehicle interior. Each door shall have an access port adjacent to the locks.

6.82 DOORS, REAR PASSAGE-HINGED- HANDLES. The doors shall be lockable from the inside and outside. All doors shall shut on molded, air-core, automotive type door seals to prevent any water from leaking into the vehicle interior. Each door shall have an access port adjacent to the locks.

6.83 STAINLESS STEEL DOOR PANELS, LOWER PASSAGE DOORS. A stainless steel panel shall be installed on the interior lower portion of each passage door. The top of the stainless steel shall be installed beneath the upholstered door panel.

6.84 STEP, ZICO RETRACTABLE – CURBSIDE PASSAGE DOOR. If the step height, from level ground to the bottom of the curbside door opening, exceeds 12” then a Zico Model VS-24-9 retractable step shall be installed. Step shall meet NFPA 1901-09 for Slip Resistance and Static Load. Step shall provide a surface area of 24” wide x 8 3/8” deep with a 7 5/8” drop. Step shall be wired to operate automatically when the Curbside passage door is opened and closed.

6.85 WINDOW, FIXED - (1) EACH REAR MODULE PASSAGE DOORS. A non-openable (fixed) window with limo tint shall be provided in each rear module passage door. The windows shall be secured with black oxide fasteners. The distance between the window glasses shall not exceed 6” to assure maximum vision to the rear. No warning lights shall be blocked from view when the rear doors are open.

6.86 WINDOW, SLIDING W/SCREEN - (1) CURBSIDE MODULE PASSAGE DOOR. An openable (sliding) window with limo tint and removable screen shall be provided in the curbside

module passage door. The window shall be secured with black oxide fasteners. No warning lights shall be blocked from view when the curbside door is open.

6.87 EXTERIOR STORAGE COMPARTMENTS DESIGN. All exterior compartments shall include these features:

- a. Baffled seep holes and all joints sealed to prevent water from splashing or seeping into the exterior compartments.
- b. Full-Length hinges on all exterior compartment doors with 3/16-Inch, two-way adjustable stainless steel hinge pins.
- c. Compartment doors flush without a protruding flange or lip.
- d. When double doors are provided, each door shall have an exterior handle, but only One (1) may be locked.
- e. All exterior compartments and passage doors shall be keyed alike.
- f. Lockable, recessed handles. A gasket shall be installed under each handle to protect the paint.
- g. All exterior compartment doors shall have aluminum diamond plate inner door skins.

6.88 EXTERIOR COMPARTMENT – LIGHTING. All exterior compartments shall be equipped with LED Strip lights in sufficient quantity and of sufficient intensity to fully illuminate the compartment.

6.89 OUTSIDE STORAGE PREFERENCES. In order to maintain consistency across the fleet, the following outside storage compartments list the preferred equipment to be carried in each compartment.

6.90 OUTSIDE STORAGE #1 - FORWARD STREETSIDE OSS#1. (Forward Street side Compartment) Shall be sized to accommodate the following equipment. This compartment shall have One (1) adjustable shelf. This compartment shall house One (1) “H” size Oxygen cylinder. The compartment door shall be held open with a spring loaded gas cylinder.

6.91 OUTSIDE STORAGE #2— CENTER STREETSIDE OSS#2. (Street side Center Compartment) Shall be sized to accommodate the following equipment: a Ferno Model 59 EZ-Glide stair chair to be located in a secure mount on the inside surface of the compartment door, set of irons with mounts, red DOT triangle box. The top of the compartment shall be on an even plane with the top of the rear street side compartment, OSS#3. Door(s) shall be held open with a spring loaded gas cylinder.

6.92 OUTSIDE STORAGE #3— REAR STREETSIDE OSS#3. (Street side Rear Compartment) Shall be constructed to provide for the maximum possible cubic foot of storage space. Compartment shall have Two (2) SCBA SCOTT 4.5 SCBAs (with mounting brackets) with 4500 psi, Thirty (30) Minute Carbon Fiber Cylinders. This compartment shall also house Two (2) complete sets of structural firefighting gear, each set to include boots, pants, jacket and helmet. Door(s) shall be held open with a spring loaded gas cylinder.

6.93 OUTSIDE #4— OSS#4 BACKBOARD/SCOOP, IMMOBILIZATION EQUIPMENT. (Rear Curbside Compartment) Shall be sized to house the following equipment one (1) IRON DUCK Long Spine Boards, one (1) FERNO Scoop Stretcher Model 65EXL and one (1) CombiCarrier II Backboard/Split Litter. Also there shall be One (1) C-Collar/CID bag measuring 24”h x 12”w x 6”d, extra adjustable C-Collars and extra STA-BLOK Head Immobilizer kits. Refer to conceptual drawing #CFD-4 for additional guidance as to the desired layout of this compartment. The compartment door shall be held open with a spring loaded gas cylinder.

6.94 OUTSIDE STORAGE #5 - FORWARD CURBSIDE --OSS#5. (Forward Curbside Compartment) Shall provide Inside/Outside storage, and shall have Two (2) adjustable shelves. This compartment shall be sized to accommodate One (1) Pediatric Bag measuring 12”h x 18”w x 14”d, One (1) Trauma Kit – Thomas Responder EMT Pack, One (1) ALS Bag – Thomas Responder EMT Pack, One (1) O2/Airway Bag (Statpacks G3 Tidal Volume) and One (1) Powered, Portable Suction device. The compartment door shall be held open with a spring loaded gas cylinder.

6.95 TURTLE TILE MAT SKID-RESISTANT (CHAR-GRAY) CURBSIDE STEPWELL. Skid resistant Char Grey TURTLE TILE matting shall be installed on the Curbside stepwell.

6.96 ASSIST HANDLES, (3) 'V' STAINLESS STEEL, (3) BLACK URETHANE. A total of Six (6) assist handles shall be provided: Three (3) 1-1/4" diameter Stainless Steel 'V' Handles, One (1) on each rear passage door and One (1) on the curbside door; and Three (3) assist handles, Two (2) handles at the rear doorway, One (1) at the curbside doorway.

6.97 RADIO ANTENNAS. Purchaser shall supply up to Three (3) Radio Antennas to be installed on the module top. Appropriate access panels shall be provided for maintenance purposes. Antenna cable shall be installed from the antenna to the Master Control Console in the cab for later radio installation.

6.98 BACK-UP CAMERA. A Back-Up Camera shall be installed over the rear module doors. Camera shall feed to integral color display in the rear view mirror.

6.99 MODULE, FRONT- WHELEN 900 SERIES – LINEAR SUPER LED. Seven (7) WHELEN 900 SERIES LINEAR SUPER LED lights shall be mounted on the front of the module, in lieu of a front lightbar. Lights to be Five (5) Red and Two (2) White. The lights shall be installed in the order of Red, Red, White, Red, White, Red, Red. All lights shall operate from one (1) switch labeled “EMERGENCY MASTER”.

6.100 MODULE, FRONT-WHELEN 900 SERIES – WHITE – ALTERNATE WIRING. The White LED lights shall additionally be wired to allow a steady burn mode or front scene lighting. Steady burn function to operate from a dedicated Console switch labeled “TAKEDOWN LIGHTS”.

6.101 MODULE, REAR- WHELEN 900 SERIES – LINEAR SUPER LED WHELEN 900 SERIES lights shall be mounted on the rear of the module. There shall be Two (2) outboard Red WHELEN 900 SERIES LINEAR SUPER LED’S, Two (2) WHELEN 900 SERIES CLEAR LED Load lights, One (1) Amber WHELEN 900 SERIES LINEAR SUPER LED in the center position. The LED lights shall operate from the Console switch labeled " EMERGENCY MASTER ". The

rear Scene/Load lights shall be automatically activated when the rear doors are opened or the transmission is in 'Reverse' gear, or from a switch on the Master Control Console labeled "REAR SCENE LIGHTS."

6.102 LIGHTS, FRONT GRILLE - WHELEN 700 SERIES LINEAR SUPER LED - RED . Two (2) WHELEN 700 SERIES Red LINEAR SUPER LED warning lights, One each side, shall be installed, with waterproof connectors, in the grille area of the chassis, and will operate from a dedicated Console switch labeled "EMERGENCY MASTER " .

6.103 LIGHTS, INTERSECTION-WHELEN 700 SERIES LINEAR SUPER LED - RED. Two (2) WHELEN 700 SERIES Red LINEAR SUPER LED warning lights shall be installed on forward front fenders of the OEM chassis, One (1) each side, and will operate from a dedicated Console switch labeled "EMERGENCY MASTER " .

6.104 LIGHTS, REAR INTERSECTION-WHELEN 700 SERIES LINEAR SUPER LED – RED. WHELEN 700 SERIES Red LINEAR SUPER LED warning lights shall be installed with waterproof connectors, above the rear wheel wells - One (1) each side, and will operate from a dedicated Console switch labeled " EMERGENCY MASTER " .

6.105 LIGHTS, REAR WINDOW-LEVEL - WHELEN 900 LINEAR SUPER LED - RED. Two (2) WHELEN 900 SERIES Red LINEAR SUPER LED warning lights shall be installed on the rear of the module at window level, One (1) each side. This will function with the other flashing warning lights, and will operate from a dedicated Console switch labeled " EMERGENCY MASTER " . These lights shall also function as brake lights whenever the brake pedal is depressed.

6.106 LIGHTS, MODULE WHELEN 900 SERIES- 4 LINEAR SUPER LED WARNING & 4 LED SCENES . WHELEN 900 SERIES LINEAR SUPER LED module warning and Halogen scene lights shall be installed. Four (4) total WHELEN 900 SERIES LINEAR SUPER LED Red warning lights shall be installed, to include Two (2) LED warning lights on the module curbside, and Two (2) LED warning lights on the module street side. These lights shall operate from a dedicated Console switch labeled "EMERGENCY MASTER". There shall be Four (4) WHELEN 900 SERIES LED Scene lights installed, Two (2) inboard of the warning lights, high on the module curbside and Two (2) inboard of the warning lights, high on the module street side. These lights shall operate from a dedicated Console switch labeled " LEFT SCENE" and "RIGHT SCENE" respectively

6.107 LIGHTS, REAR TAIL WHELEN 600 LED STOP, TURN AND BACKUP. One (1) pair each WHELEN 600 SERIES MAXIMUM INTENSITY LED Stop/Tail and Amber Turn Arrows, with chrome bezels shall be installed on the rear of the module. The Back-Up lights shall be WHELEN 600 SERIES White MAXIMUM INTENSITY LED lights in chrome bezels.

6.108 TURN SIGNALS – FRONT MODULE Install Amber LED turn arrow lights on the front of the module. Lights to be mounted as high as possible on the outer corners of module front and below the WHELEN 900 SERIES warning lights.

6.109 LIGHT, LICENSE PLATE. One (1) license lamp shall be installed on the rear of the module, lower left side.

6.110 LIGHTS, LED MARKER/CLEARANCE LIGHTS. The vehicle shall have LED Marker and Clearance - ICC lights installed on the front, rear and both sides of the body to meet all federal lighting requirements FMVSS 108.

6.111 LIGHTS, GROUND LIGHTING. The vehicle shall have LED Grounding lighting on driver side of apparatus, passenger side of apparatus, and rear of apparatus. On with door open or dedicated switch

6.112 SIREN, FEDERAL SIGNAL E-Q2B WITH MICROPHONE. A FEDERAL SIGNAL E-Q2B Siren Amplifier with digital output control head and microphone shall be flush-mounted in the Master Control Console located in the cab. The siren shall be capable of hands-free operation. **NO EXCEPTIONS OR SUBSTITUES.**

6.113 SIREN SPEAKERS, CAST PRODUCTS- SA-4316-07G3551. CAST PRODUCTS SA-4316-07G3551 Dual 100-Watt cast aluminum siren speakers shall be installed in the front bumper.

6.114 SIREN, FEDERAL SIGNAL RUMBLER. A FEDERAL SIGNAL RUMBLER – 3 shall be installed as a secondary warning device. The RUMBLER shall be activated from the factory horn button on the steering wheel. **NO EXCEPTIONS.**

6.115 POWER LOCKS- PASSAGE, OSS DOORS, HIDDEN SWITCH-REMOTE-KEYLESS. Power door locks shall be included on module passage doors and all outside storage compartments. The locks shall be activated from switches located at the interiors of the rear and curbside module doors, as well as the OEM chassis cab door switches. An exterior lock switch will also be included and hidden on the exterior rear street side of the vehicle under a false chrome vent cover so as to be easily accessible. A keyless entry system shall be installed. The system shall include Two (2) remote Entry/Lock KEY FOB transmitters. The system will activate power to lock and unlock all powered locks provided on the cab and on the module.

6.116 PADS, HEAD AND BACK. Vinyl upholstered, foam cushioned head/back pads shall be installed as follows: One (1) on the lower edge of the upper front wall cabinet (above the partition doorway or window), One (1) above the rear doors, One (1) above the side door, and One (1) on the curbside wall behind the squad bench. The pads shall be covered with color coordinated vinyl upholstery material.

6.117 PADDED EDGING PROTECTION. Padded corner edging shall be installed where necessary on exposed corners and edges in the patient care compartment for Patient and Attendant protection.

6.118 STAINLESS STEEL WALL PROTECTION. Brushed stainless steel panels shall be provided on the street side wall from the bottom of the CPR seat cushion down to the flooring material to protect this area from damage.

6.119 AISLE & FLOOR DIMENSIONS - REAR PATIENT COMPARTMENT. Respondent shall provide detailed specifications for aisle and floor dimensions including the distance between the

left wall and the edge of the squad bench and the floor from the rear doors to the partition doorway (with the rear doors closed).

6.120 HEADLINER - REAR PATIENT COMPARTMENT. The Respondent shall provide detailed specifications for their standard headliner construction materials.

6.121 EMBLEMS / SIGNS - REAR PATIENT COMPARTMENT. Two (2) "*NO SMOKING / OXYGEN EQUIPPED / FASTEN SEAT BELTS*" signs shall be provided. One (1) sign shall be installed in the cab and One (1) above the Oxygen outlets in the Patient Care Compartment street side cabinet.

6.122 UPHOLSTERY. All cushions, headpads, door panels and seats shall be covered with vinyl upholstery material. The vinyl and all foam cushion material shall comply with FMVSS #302 Flame Spread requirements.

6.123 LONPLATE II, NON-SLIP EMBOSSED DIAMOND PLATE. The floor in the Patient Care Compartment shall be covered with LONSEAL brand "LONCOIN II" (or comparable alternative) Non-Slip, (Embossed Diamond Plate) resilient sheet vinyl flooring material, which shall be covered 3-inches up the wall on the street side, and to the top of the squad bench base on the curbside. The flooring material shall be stripped and waxed before delivery.

6.124 CABINET FACING. All exposed sidewalls, the partition wall (on the Patient Care Compartment side only), and the cabinet faces shall be covered with a minimum of high- pressure plastic laminate material, however stainless steel preferred.

6.125 PASS-THROUGH - CAB TO REAR PATIENT COMPARTMENT. A pass-through door separating the cab from the rear patient compartment shall be provided. Any sliding panels used in this pass-through should be easily removable without the use of tools.

6.126 COT FASTENER. All necessary provisions shall be made for the installation of a Stryker Power-Load Cot Fastener system. Cot shall be positioned in such a way as to allow at least 8" of space between end of cot and rear doors and in proper alignment with CPR seat.

6.127 LIGHT, ATTENDANT CONTROL PANEL AREA. A LED strip light, of appropriate length, with integral switch shall be mounted under Attendant's Control panel.

6.128 DOME LIGHTS, SUPER-LED - (8) WHELEN #80C0EECR. Eight (8) Dual Intensity White LED dome lights, WHELEN 80C0EECR shall be provided in the Patient Care Compartment, four (4) on each side. The dome lights shall have high and low intensity Three-way switching between the Attendant Control panel (ACP) and Master Control Console (MCC). The low dome lights shall be illuminated when the Patient Care Compartment side or rear doors are opened. Dome lights shall also be dimmable by installation of WHELEN Model 8dimctrl Dimmer control.

6.129 LIGHT, ELECTRICAL COMPARTMENT. A small, 12volt light will be located in the electrical compartment, the light shall be wired, battery-hot to activate when the Electrical Compartment door is in the open position. The light shall be off when the Electrical Compartment door is in the closed position.

6.130 PRE-SHIFT INSPECTION LIGHTING / TIMER. A switch shall be installed that shall activate enough lighting for the purpose of conducting a Pre-Shift inspection. These lights shall be operable without engaging any other switches and shall be on a field programmable timer initially set to turn lights off after 15 minutes.

6.131 EXHAUST VENTILATOR, 3-SPEED . A three-speed, 285 CFM minimum electric exhaust fan shall be provided and located in the curbside cabinet in the Patient Care compartment. The exhaust fan shall be operated from a switch on the ACP (Attendant Control Panel). The exhaust system shall have a regulating grille inside and a louvered grille outside. The exhaust system shall vent through the side of the vehicle, not through the roof.

6.132 (5) 115VAC INTERIOR DUPLEX OUTLETS. Five (5), 2-wire +plus ground hospital-grade duplex outlets shall be installed, with wiring run to and powered by the shoreline when connected or by the Inverter when the vehicle is mobile. Power shall automatically switch from the shoreline to the inverter when the vehicle is started. In the Patient Care Compartment two (2) outlets shall be installed in the street side cabinet action area, One (1) forward and One (1) rearward of the CPR seat. Both outlets shall be capable of supplying 115VAC to the monitoring equipment. The third outlet shall be installed in the lower front wall inside/outside compartment. The fourth on the curbside wall by the bench seat counter. The fifth outlet shall be installed in the cab, on passenger side of the rear area of the Master Control Console. An indicator lamp shall be located within each 115VAC outlet as a line monitor to indicate a live circuit. The outlets shall be labeled, "115VAC".

6.133 (3) 12VDC INTERIOR (USB TYPE) OUTLETS. One (1) 12VDC "KUSSMAUL USB Dual Port 4.8, part#091-219-5" outlet shall be installed next to each of the 115VAC outlets located at the forward Streetside wall, Curbside wall and cab MCC as described in 6.132.

6.134 (2) 12VDC CIGAR LIGHTER OUTLET One (1) 12VDC Cigar lighter socket outlet shall be installed in next to each of the 115VAC outlets located at the forward streetside wall and front wall inside/outside compartment as described in 6.132.

6.135 KNOX BOX – KeySecure. A Knox KeySecure 5 will be mounted in the cab. All power needed for these to function shall be provided. Key code information For Knox and final mounting location will be provided at pre-construction meeting.

6.136 SHARPS AND TRASH CONTAINERS - SQUAD BENCH END. A removable sharps container and a trash container shall be installed in the forward end of the squad bench base

6.137 HEAT/AIR CONDITIONING, MANUAL/AUTO SELECT, 5-SPEED BLOWER. A high capacity Heater/Air Conditioner system with capacity size designed in accordance with the module needs and with a 5-speed blower shall be provided for high volume air movement with minimal noise. The Heater/Air Conditioner air return shall be filtered to minimize contamination of the Heater/Air Conditioner cores. The cab and module environmental systems shall be simultaneously capable of heating in the front while cooling in the rear and vice-versa. A thermostatically controlled rear system shall be provided for heating and air conditioning the Patient Care Compartment. The temperature, whether heating or cooling shall be controlled by a

thermostat built into the Attendant Control Panel, located in the street side cabinet. The thermostat shall have Five (5) blower speeds. Heating and cooling may be selected automatically and manually. The Heater/Air Conditioner system shall function only when the ignition system is on. The rear heater shall have EPDM/NOMEX heater hoses. The rear air conditioner shall have BARRIER air conditioner hoses for R-134A refrigerant. A switch shall be located on the MCC (Master Control Console) to turn on/off the environmental system from the cab.

6.138 AUXILIARY CONDENSOR. A/C condenser unit or equivalent shall be installed on a bracket on the front of the module above the cab roof.

6.139 AUXILLARY AC/HEAT UNIT. An auxillary AC/Heat unit, independent of primary system, for shoreline operated climate control shall be installed. This AUX. unit is to operate automatically as the 110V unit shoreline (30 AMP) is plugged in, to provide heating and cooling of parked vehicle with thermostat control. Vehicle shall automatically switch to conventional climate control when running on engine power.

6.140 ATTD SEAT - EVS HiBAC, INTEGRAL CHILD, EVS SWIVEL BASE. A rear facing EVS HiBAC attendant seat shall be installed at the head of the patient cot. The seat shall be equipped with a sliding base with swivel capabilities and incorporate an integral child safety restraint system. The seat shall be covered with color-coordinated vinyl and equipped with automatic retracting safety seat belts.

6.141 CPR SEAT. A CPR seat will be installed on the street side of the Patient Care Compartment, aft of the main action area counter. The seat, backrest, and sides of the seat shall be covered with cushioned vinyl. The CPR seat and cot mounting position shall be oriented so that the CPR seat is properly aligned so that the aft most side of the seat is aligned with the middle of the cot.

a. SEAT RESTRAINTS. All designed seating positions in the patient care module shall be supplied minimally with 4 point restraint systems for occupants.

6.142 SQUAD BENCH - BASE. The squad bench base shall be constructed for maximum storage capacity. Respondent shall provide detailed explanation of their construction techniques for the squad bench base. There shall be a cabinet installed forward of the bench seat and after the opening of the curbside door. The cabinet shall be a minimum of 35" high, have a countertop, and there shall be three (3) drawers in the cabinet. There shall be two (2) drawers with a minimum interior dimension of 4.50" high X 9" wide X 13.50" deep. The drawers shall open towards the bench seat and shall have locking flush pull latches. There shall be one (1) drawer with a minimum interior dimension of 9.25" high X 12.25" wide X 13.50" deep. The drawer shall open towards the aisle and house the trash can and sharps container described in 6.136, and shall have locking flush pull latches.

6.143 SQUAD BENCH - LID FASTENER, AUTOMATIC LATCHING. An automatic latching fastener shall be installed to secure the squad bench lid in the closed position.

6.144 CABINET CONSTRUCTION-INTERIOR. Respondent shall provide detailed explanation of their construction techniques for the interior cabinets.

a. **LIGHTING.** All interior cabinets shall be equipped with LED Strip lights in sufficient quantity and of sufficient intensity to fully illuminate the compartment.

6.145 RESTOCKING HINGES- INTERIOR CABINETS. All cabinet frames with sliding doors shall be equipped with restocking hinges and gas assists. **NO EXCEPTIONS.**

6.146 CABINETS DOORS-SLIDING-CLEAR. Sliding cabinet doors shall be nominally 1/4" thick clear acrylic material. The sliding cabinet doors shall be installed in aluminum track that shall be lined with PPL insert to eliminate rattles and prevent doors from opening during transit. An edge mounted aluminum handle shall be installed on each sliding cabinet door.

6.147 CABINETS, INTERIOR -ALS - ADVANCED LIFE SUPPORT. Respondent shall supply detailed specifications for construction of interior cabinets and storage including cabinet layout options, door opening dimensions and interior dimensions. Provided photos are for illustrative purposes only and are intended to convey a general impression of desired cabinet layout. Respondent shall include any and all standard compartment layout options for their particular manufacturer. There shall be Two (2) action areas. One (1) shall be located to the right of the attendant seat with work area dimensions of approximately 14.5" High x 47.50" Wide x 17.25" Deep. The second shall be located to the rear of the CPR seat with work area dimensions of approximately 21.5" High x 18.25" Wide x 17.25" Deep. Both action areas shall be covered with a seamless, durable and stain resistant material that is easily decontaminated and with a one-inch lip on all sides, to prevent equipment from sliding off.

6.148 CABINET, LOCKING DRUG BOX. A cabinet for the securing of narcotic drugs shall be provided inside the Patient Care Compartment. This cabinet shall be a NarcBox XL –Narc Safe 12v and installed in a location to be determined during prebuild meeting.

6.149 CABINET, LOWER FRONT WALL. The lower front inside/outside wall cabinet shall be open to the patient compartment with a rollup door. Cabinet shall have a minimum of Two (2) adjustable shelves on unistrut adjustable track brackets. LED strip lights shall be provided in sufficient quantity and of sufficient intensity level to fully illuminate all areas of this compartment. There shall be an aluminum beveled ramp edging installed on the edge of each shelf. The exterior of the cabinet shall be covered with color coordinated high-pressure plastic laminate material. The interior shall be covered with multi-use Polychromatic specialty coating.

6.150 SQUAD BENCH STORAGE. A storage area shall be provided in the squad bench base. The interior dimensions of the storage area shall be as large as possible.

6.151 OXYGEN CYLINDER STORAGE. Provisions shall be made for the vertical storage of One (1) "H" Oxygen cylinder in the #1 Outside Storage Compartment (front street side.) The cylinder shall be easily removable for refilling from outside the vehicle. A spring loaded, hinged acrylic access door shall be installed to provide access to the Oxygen cylinder valve. The Oxygen Compartment shall be provided with a vent of at least 9 square inches, to permit any leaking gas to dissipate to the exterior of the ambulance. The Oxygen cylinder shall be secured with a minimum of Three (3) restraining devices, meeting AMD STANDARD 003, Oxygen tank retention system requirements. A tethered cylinder changing wrench shall be provided and

secured in the Oxygen cylinder compartment. An adjustable shelf shall be installed in the area above Oxygen storage. The purchaser shall provide the Oxygen cylinder. Provisions shall be made for the secure storage of Two (2) "D" size Oxygen cylinders in the Patient Care Compartment.

6.152 OXYGEN SYSTEM. Four (4) OHIO MEDICAL, quick release wall outlets shall be installed: Two (2) flush mounted outlets located in the face of the ACP (Attendant Control Panel) on the street side, and One (1) flush mounted outlet in the forward curbside wall, approximately 18"– 24" above squad bench (at forward end of the squad bench), and One (1) in the ceiling above the cot. The Oxygen system shall be completely installed and include a pre-set Oxygen regulator with a cylinder pressure gauge and a 200 PSI safety valve with all necessary piping and connections. The Oxygen system shall be completely low pressure and the regulator shall be fastened directly to the cylinder. The regulator shall be set to operate at approximately 50 PSI. The Oxygen cylinder shall be installed so it may be easily turned on and off at the main cylinder valve. Flexible conductive Oxygen hose with a minimum 900 lbs. Burst rating shall be installed between the regulator and the Oxygen receptacles. The system shall be tested and tagged in conformance with NFPA-56-F and KKK-A-1822-F. The electric Oxygen system shall be provided with an On/Off switch on the ACP (Attendant Control Panel). A readily accessible Emergency manual bypass valve shall be provided in the Patient Care area.

- a. There shall also be a digital Pressure Gauge for the Oxygen system on the ACP (Attendant Control Panel).

6.153 ASPIRATOR SYSTEM - IMPACT #324 SELF-CONTAINED-RECESSED . A suction system with Bemis 1200ml disposable canister shall be mounted on the main action area counter. This system will be self-contained. The electric vacuum pump shall be mounted in a manner to reduce noise and vibration in the top front corner of streetside compartment. The suction aspirator system shall provide a free airflow of at least 20- LPM and achieve a minimum of 300 mm Hg Vacuum within four (4) seconds after the suction tube is clamped off. The system includes a vacuum control and shut-off valve for manual control of vacuum flow. operated from a switch on the ACP (Attendant Control Panel.) The pump performance shall comply with KKK-A-1822-F requirements. The exhaust shall be vented to the exterior of the vehicle.

6.154 GRAB RAIL-1-1/4" DIAM. X 64" L. OVER BENCH . A 1-1/4" diameter x 64" long stainless steel grab rail will be included on the ceiling over the squad bench area for attendant/patient balance control. The grab rail will be installed securely to the ceiling/module super structure with Two (2) mounting brackets.

6.155 GRAB RAIL, 1-1/4" DIAM. X 96" L. IN CEILING OVER PATIENT COT. A 1-1/4" diameter x 96" long stainless steel grab rail shall be installed on the ceiling for attendant/patient balance control. The grab rail shall be installed securely to the Ceiling/module super structure with Three (3) mounting brackets.

6.156 IV HANGERS, CEILING RECESSED - CAST PRODUCTS #IV2008-1 Two (2) CAST PRODUCTS "#IV2008-1" recessed, dual ceiling I.V. hanger shall be provided. Installed one (1) on each side of the cot.

6.157 PAINT PROCEDURE . All painted module body surfaces shall be thoroughly cleaned with wax and grease remover and hand dried. The Body shall then be completely sand blasted using a fine material. It shall then be filled with a premium body filler, if needed, sanded smooth and primed. All paint preparation procedures to be in accordance with paint manufacturers recommendations.

6.158 PAINT, MODULE. The module shall be painted Red (FLNA 3846) to match the current fleet.

6.159 PAINT, CAB. The cab of the vehicle including doorjambes shall be painted to match the color of the modular body.

6.160 REFLECTIVE STRIPPING – REAR CHEVRON MARKINGS. The rear of the vehicle shall be covered, to the greatest extent possible, excluding rear entry doors, with Red and Lime-Yellow SCOTCHLITE in an upside down “V” pattern to meet or exceed federal regulations. The Lime-Yellow background material will be 3M DIAMOND GRADE DG# FLOURESCENT YELLOW GREEN sheeting 4083. The Red, Six inch; Diagonal stripes will be SCOTCHLITE ELECTRONIC CUTABLE FILM 1172. Striping to match existing 2017 Ambulances. **NO EXCEPTIONS.**

6.161 LETTERING AND STRIPING. Lettering and striping to match the current fleet. See attached image as reference only.

- a. A minimum of 6" x 2" piece of Red reflective SCOTCHLITE tape or comparable materials/devices shall be installed on the lower portion of each outside storage compartment door for roadside visibility.

6.162 MODULE BODY TECHNIQUES. Provide explanation and description of construction techniques for an all aluminum module body, including material thicknesses and alloy types;

6.163 ATTENDANT CONTROL PANEL TECHNIQUES. Provide explanation and description of construction techniques for an Attendant Control Panel, which shall control all equipment installed in the Patient Care Compartment. The explanation shall be included in the Proposal Binder under **TAB IV-A.**

6.164 MODULE CAB CONNECTION. Provide explanation and description of construction techniques for joining the module to the cab

6.165 TECHNIQUES THERMAL INSULATION. Provide explanation and description of construction techniques for thermal and acoustical insulation of the Patient Care Compartment, including doors, cabinets, walls and floor surfaces

6.166 TECHNIQUES REAR STEP/BUMPER. Provide explanation and description of construction techniques for the rear step/bumper. Rear bumper must include a step, and be able to accommodate a Stryker Power Load Cot System.

6.167 TECHNIQUES REAR MODULE DOORS. Provide explanation and description of construction techniques for the rear module doors, including material thicknesses and alloys used, latching and locking devices, etc.

6.168 MONITOR - Color A minimum of a color 4.3" LCD/ LED screen and auxiliary video inputs will be provided in the cab and mounted in such a way as to not create a visual obstruction for the driver, anymore than a standard rearview mirror, nor obstruct or hinder any vehicle controls, accessories or safety systems. Monitor will continuously display the camera feed from the patient compartment camera except when the vehicle is placed into Reverse gear, at which time it will automatically switch to the feed from the back-up camera. Upon the gear selector being moved out of Reverse, display will automatically revert back to patient compartment camera feed.

6.169 LOOSE EQUIPMENT. The following equipment shall be shipped loose with each ambulance: **NO EXCEPTIONS**

- a. Sure Temp Plus 690 Wall-Mount Electronic Thermometer with Interchangeable Oral Probe Well (item # 179400),
- b. Two (2) SCBA Brackets – Low profile High Cycle Walkaway SCBA Bracket w/ Strap – Zico 1066 (Item # KD-FHLP-6-SF),
- c. Irons Set – Fire Hook Unlimited DT – 3, 8lbs. Force Axe, pro-bar 30" (item # DT-3),
- d. Irons Mount – Pactools K5003 Ironslok Kit (item #K5003),
- e. Technimount series 25 Bracket – Monitor Mount (item # 100-20-UN)
- f. Two (2) Streamlight Stinger LED Flashlights with Standard Chargers.

6.170 STRYKER POWER-LOAD COT RESTRAINT SYSTEM. Provide pricing for furnishing and installing a new Stryker Power-Load Cot Restraint System. Pricing to include Stryker Pro-Care Protect Power-Load 7 year service contract. **NO EXCEPTIONS**

6.171 STRYKER POWER-PRO XT AMBULANCE COT. Provide pricing for furnishing a Stryker Power-PRO XT powered ambulance cot with the following options; XPS, Powerload compatible, Knee Gatch/Trendelenburg, steer lock, Fowler O2 bottle holder, pocketed back rest pouch, head end storage flat and base storage net. Pricing to include Stryker Pro-Care Protect+ 7 year service contract. **NO EXCEPTIONS**

OPTIONS

Respondents shall provide pricing for each of the following options:

O6.1 SLIDING DOOR – MODULE CURBSIDE ENTRY. If the manufacturer routinely offers a sliding curbside module entry door, the Respondent shall include an OPTION price and provide construction details for a sliding curbside module entry door.

O6.2 WHEELS. Respondent shall supply pricing for painting all six (6) 19.5” steel wheels/rims gloss black.

If Manufacturer routinely offers alternate curbside wall seating and cabinetry designed to allow personnel to remain seated and belted while still providing patient care then provide construction details and drawings. The item below is provided for general guidance.

O6.3 SLIDING ATTENDANT SEAT. An attendant seat with a 5-point harness shall be installed on the Curb side interior side of the patient compartment In place of the squad bench. This seat shall be installed on a 48” track that will allow the seat to slide forward and aft. The seat shall have ability to lock into place every 4”. The seat shall be installed to allow easy access to the patient on the cot.

Current Graphics Package and Exterior Compartment Layout (For Illustrative Purposes Only)

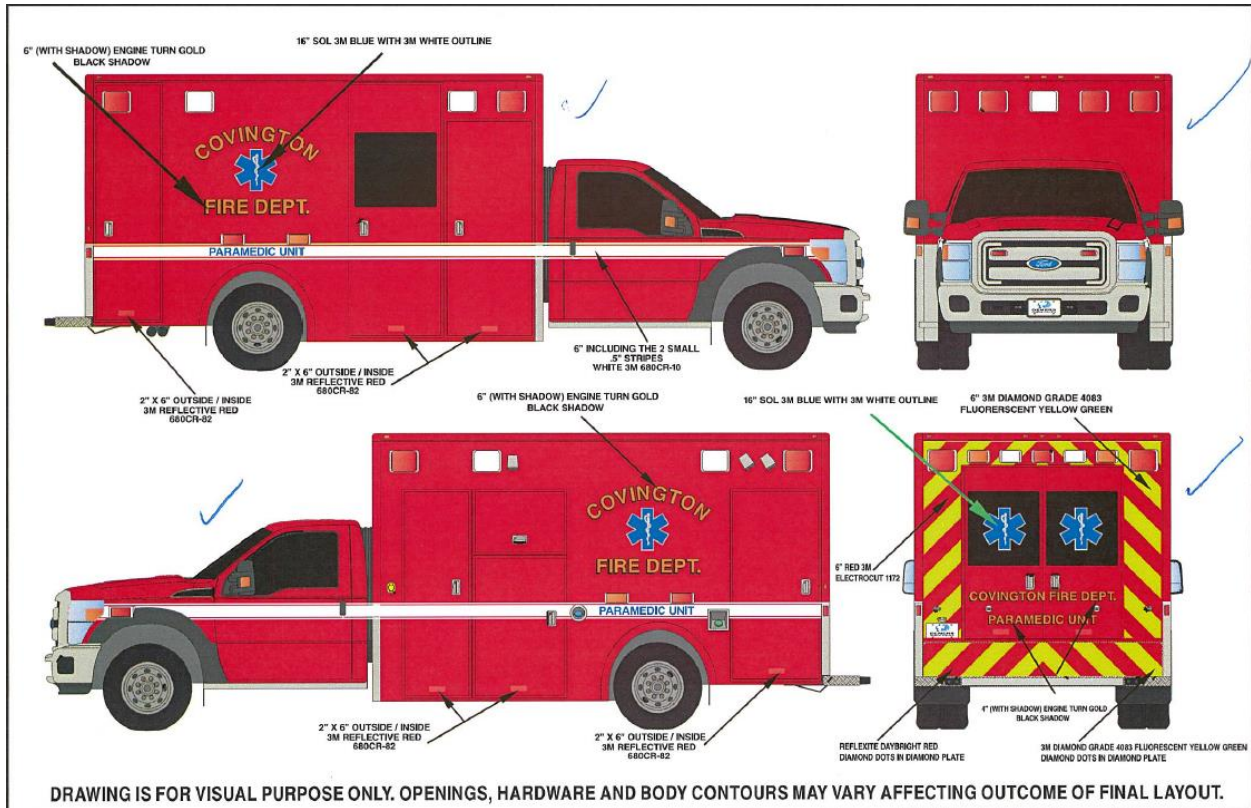

Hidden Door Lock Switch under fake vent cover on left rear of module



Current Interior Compartment Layout Examples (For Illustrative Purposes Only)

Streetside

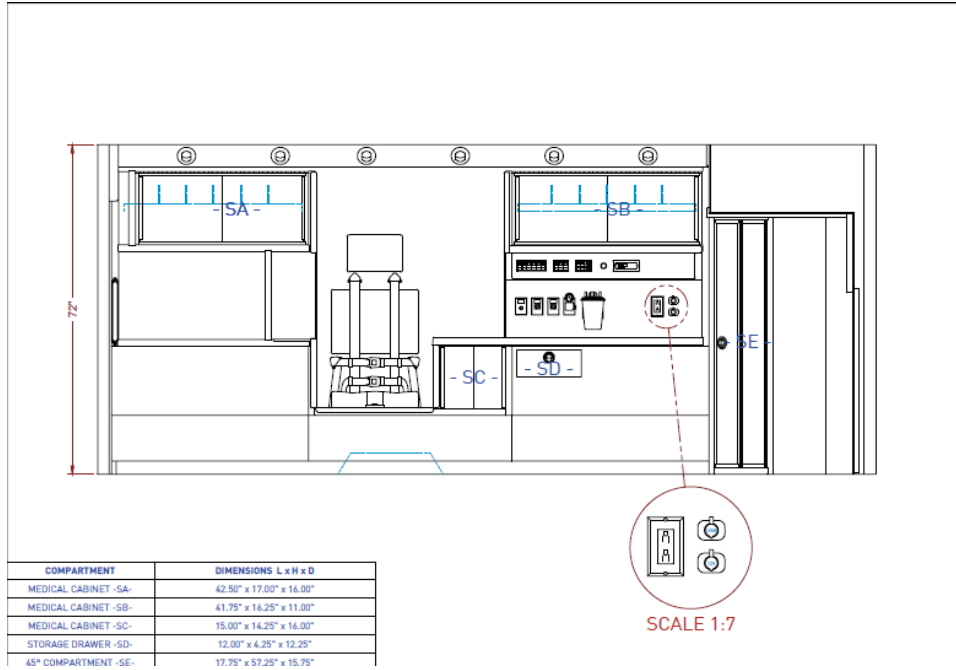

Curbside

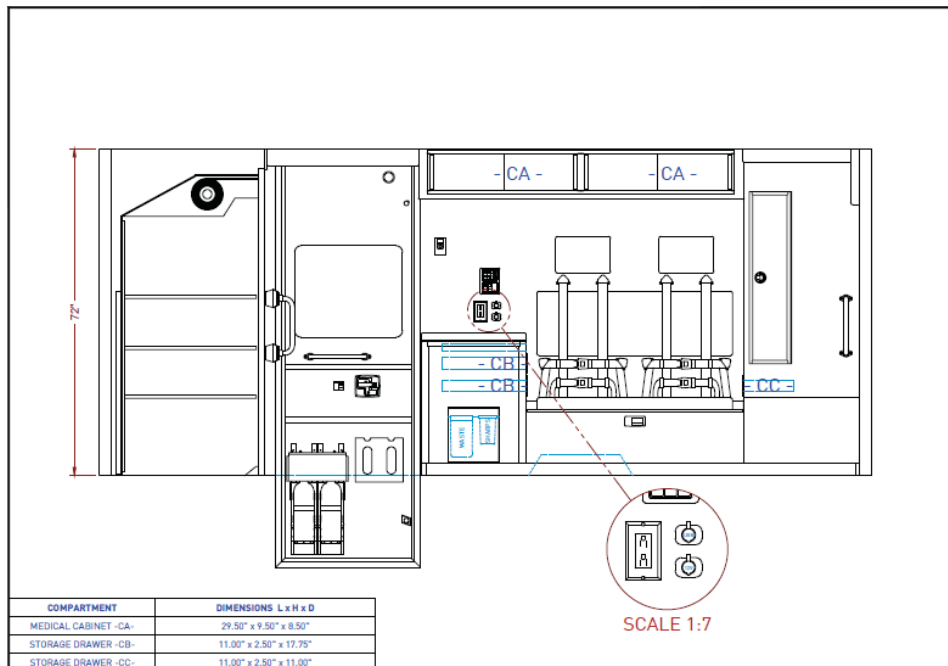

Front Wall



COMPARTMENT	DIMENSIONS L x H x D
IV WARMER COMP. -FA-	31.75" x 56.75" x 30.25"

Overhead View

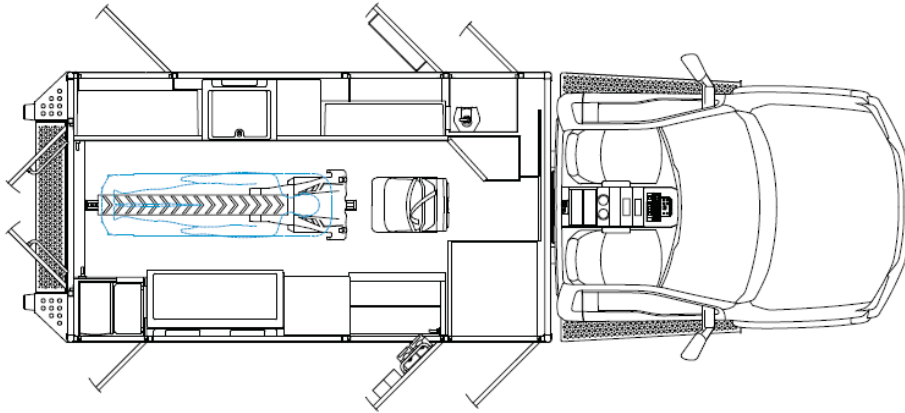

**CITY OF COVINGTON
RESPONDENT CHECKLIST
INCLUDE IN PROPOSAL BINDER**

<u>ATTACHMENT</u>	<u>PROVIDED (Y/N)</u>	<u>EXPLANATION, IF NO</u>
MASTER BID WORKSHEET (TAB 2)		
TERMS AND CONDITIONS WORKSHEET (TAB 2)		
SPECIFICATION WORKSHEET (TAB 3)		
EXCEPTION AND EXPLANATORY ADDENDUM (TAB 3)		
STATEMENT OF QUALIFICATIONS & CAPACITY (TAB 4)		
SIMILAR CONTRACTS (TAB 4)		
LETTERS OF REFERENCE (TAB 4)		
STATEMENT OF FINANCIAL CAPACITY (TAB 5)		
PROFILE OF MANUFACTURING PROCESS (TAB 6)		
SERVICE AND SUPPORT (TAB 7)		
PROPOSED CONSTRUCTION SCHEDULE (TAB 8)		
SITE VISIT COSTS/ PERSON (TAB 8)		
DESCRIPTION OF TRAINING PROGRAM (TAB 9)		
SAMPLE INSTRUCTION MANUAL (TAB 9)		
REQUIRED CERTIFICATIONS (TAB 10)		
LEGAL DOCUMENTS (TAB 11)		
INVOICE PRICE QUOTE OR WORK ORDER (TAB 12)		
WARRANTIES (TAB 13)		

**CITY OF COVINGTON
MASTER BID WORKSHEET
INCLUDE IN PROPOSAL BINDER**

COMPANY NAME:	
CONTACT PERSON:	PHONE:
TITLE:	EMAIL:
MAILING ADDRESS:	

Instructions: Please indicate each vehicle bid and list Base Price, which must include all fees, delivery charges, or other associated costs. Please also detail any discounted price based upon pre-payment, bulk, or other associated discounts.

VEHICLE/EQUIPMENT	BID? (Y/N)	PER UNIT PRICE W/O Options	PER UNIT PRICE W/ Options
Ambulance #1 built Type I Ford F-450 4x4			
Ambulance #2 built Type I Ford F-450 4x4			
OPTIONS			
		Option Price	
Sliding Door—Module Curbside Entry (O6.1)	If applicable		
Stryker Power-Load Cot Restraint System w/ Protect Power Load-7Year(6.170)	Mandatory		
Stryker Power-Pro XT Ambulance Cot w/ Protect+ Power Cot – 7Year(6.171)	Mandatory		
Wheels (O6.2)	If applicable		
Sliding Attendant Seat (O6.3)	If applicable		

ACKNOWLEDGEMENT

Pursuant to and in accordance with the above stated RFP, the undersigned hereby declares that they have examined the RFP documents and specifications for the item(s) listed herein. The undersigned proposes and agrees, if their quotation is accepted to furnish the item(s) submitted below, including delivery to destination stated on opening page in accordance with the delivery schedule indicated below and according to the prices, products/services information submitted.

SUBMITTED BY: _____

DATE SUBMITTED: _____

CITY OF COVINGTON
TERMS AND CONDITIONS WORKSHEET
INCLUDE IN PROPOSAL BINDER

Instructions: After reviewing the terms and conditions provided in Section 5 above, complete the following worksheet to confirm acceptance of all terms and conditions, or, where, applicable indicate rejection and propose substitute terms.

TERM	ACCEPT	REJECT	Basis for rejection; Proposed Substitution
5.1			
5.2			
5.3			
5.4			
5.5			
5.6			
5.7			
5.8			
5.9			
5.10			
5.11			
5.12			
5.13			
5.14			
5.15			
5.16			
5.17			
5.18			
5.19			
5.20			

Acknowledgement of Terms and Conditions

Respondent acknowledges that it has reviewed the above terms and conditions and has indicated its acceptance or rejection in the spaces provided above.

Entity Name

By: _____

Title: _____

CITY OF COVINGTON
SPECIFICATION WORKSHEET
INCLUDE IN PROPOSAL BINDER

SPEC #	Complies Y/N	If N, Explain (a) how the proposal deviation is different; (b) how the deviation meets or exceeds the specifications; and (c) why it is necessary.
6.1	NO EXCEPTIONS	
6.2		
6.3		
6.4		
6.5		
6.6		
6.7	NO EXCEPTIONS	
6.8		
6.9		
6.10		
6.11		
6.12		
6.13		
6.14		
6.15		
6.16		
6.17		
6.18		
6.19		
6.20	NO EXCEPTIONS	
6.21		
6.22		
6.23		
6.24		
6.25		
6.26		

SPEC #	Complies Y/N	If N, Explain (a) how the proposal deviation is different; (b) how the deviation meets or exceeds the specifications; and (c) why it is necessary.
6.27		
6.28		
6.29		
6.30		
6.31		
6.32		
6.33		
6.34		
6.35		
6.36		
6.37		
6.38		
6.39		
6.40		
6.41		
6.42		
6.43		
6.44		
6.45		
6.46		
6.47		
6.48		Provide explanation under TAB IV-A
6.49		
6.50		
6.51		
6.52		

SPEC #	Complies Y/N	If N, Explain (a) how the proposal deviation is different; (b) how the deviation meets or exceeds the specifications; and (c) why it is necessary.
6.53		
6.54		
6.55		
6.56		
6.57		
6.58		
6.59		
6.60		
6.61		
6.62		
6.63		
6.64		
6.65		Provide explanation under TAB IV-A
6.66		Provide explanation under TAB IV-A
6.67		Provide explanation under TAB IV-A
6.68		
6.69		Provide explanation under TAB IV-A
6.70		
6.71		
6.72		Provide explanation under TAB IV-A
6.73		
6.74		
6.75		
6.76		
6.77		
6.78		

SPEC #	Complies Y/N	If N, Explain (a) how the proposal deviation is different; (b) how the deviation meets or exceeds the specifications; and (c) why it is necessary.
6.79		
6.80		
6.81		Provide explanation under TAB IV-A
6.82		
6.83		
6.84		
6.85		
6.86		
6.87		
6.88		
6.89		
6.90		
6.91		
6.92		
6.93		
6.94		
6.95		
6.96		
6.97		
6.98		
6.99		
6.100		
6.101		
6.102		
6.103		
6.104		

SPEC #	Complies Y/N	If N, Explain (a) how the proposal deviation is different; (b) how the deviation meets or exceeds the specifications; and (c) why it is necessary.
6.105		
6.106		
6.107		
6.108		
6.109		
6.110		
6.111		
6.112	NO EXCEPTIONS	
6.113		
6.114	NO EXCEPTIONS	
6.115		
6.116		
6.117		
6.118		
6.119		Provide explanation under TAB IV-A
6.120		Provide explanation under TAB IV-A
6.121		
6.122		
6.123		
6.124		
6.125		
6.126		
6.127		
6.128		
6.129		
6.130		

SPEC #	Complies Y/N	If N, Explain (a) how the proposal deviation is different; (b) how the deviation meets or exceeds the specifications; and (c) why it is necessary.
6.131		
6.132		
6.133		
6.134		
6.135		Location TBD at Pre-Construction
6.136		
6.137		
6.138		
6.139		
6.140		
6.141		
6.142		
6.143		
6.144		Provide explanation under TAB IV-A
6.145	NO EXCEPTIONS	
6.146		
6.147		Provide explanation under TAB IV-A
6.148		Location TBD at Pre-Construction
6.149		
6.150		
6.151		
6.152		
6.153		
6.154		
6.155		
6.156		
6.157		

SPEC #	Complies Y/N	If N, Explain (a) how the proposal deviation is different; (b) how the deviation meets or exceeds the specifications; and (c) why it is necessary.
6.158		
6.159		
6.160	NO EXCEPTIONS	
6.161		
6.162		Provide explanation under TAB IV-A
6.163		Provide explanation under TAB IV-A
6.164		Provide explanation under TAB IV-A
6.165		Provide explanation under TAB IV-A
6.166		Provide explanation under TAB IV-A
6.167		Provide explanation under TAB IV-A
6.168		
6.169	NO EXCEPTIONS	
6.170	NO EXCEPTIONS	
6.171	NO EXCEPTIONS	
O6.1		
O6.2		
O6.3		

interest with said submitter in his business; and

- (e) did not include in his bid price any fees, dues, charges, or assessments because required to do so by reason of his membership in or affiliation with any association, organization, corporation, partnership, company, individual or group of individuals, or because of any agreement or understanding with anyone that he would do so.

Signed: _____

Title: _____

Subscribed and sworn to before me this ____ day of _____, 20__.

(SEAL OF NOTARY HERE)

Notary Public in and for

My commission expires _____.

**CERTIFICATION AGAINST CONFLICTS OF INTEREST,
GRATUITIES, AND KICKBACKS**

Respondent certifies its understanding and compliance with *KRS 45A.455*, which states:

1. It shall be a breach of ethical standards for any employee with procurement authority to participate directly in any proceeding or application; request for ruling or other determination; claim or controversy; or other particular matter pertaining to any contract, or subcontract, and any solicitation or proposal therefor, in which to his knowledge:

(a) He, or any member of his immediate family has a financial interest therein; or

(b) A business or organization in which he or any member of his immediate family has a financial interest as an officer, director, trustee, partner, or employee, is a party; or

(c) Any other person, business, or organization with whom he or any member of his immediate family is negotiating or has an arrangement concerning prospective employment is a party. Direct or indirect participation shall include but not be limited to involvement through decision, approval, disapproval, recommendation, preparation of any part of a purchase request, influencing the content of any specification or purchase standard, rendering of advice, investigation, auditing, or in any other advisory capacity.

2. It shall be a breach of ethical standards for any person to offer, give, or agree to give any employee or former employee, or for any employee or former employee to solicit, demand, accept, or agree to accept from another person, a gratuity or an offer of employment, in connection with any decision, approval, disapproval, recommendation, preparation of any part of a purchase request, influencing the content of any specification or purchase standard, rendering of advice, investigation, auditing, or in any other advisory capacity in any proceeding or application, request for ruling or other determination, claim or controversy, or other particular matter, pertaining to any contract or subcontract and any solicitation or proposal therefor.

3. It is a breach of ethical standards for any payment, gratuity, or offer of employment to be made by or on behalf of a subcontractor under a contract to the prime contractor or higher tier subcontractor or any person associated therewith, as an inducement for the award of a subcontract or order.

4. The prohibition against conflicts of interest and gratuities and kickbacks shall be conspicuously set forth in every local public agency written contract and solicitation therefor.

5. It shall be a breach of ethical standards for any public employee or former employee knowingly to use confidential information for his actual or anticipated personal gain, or the actual or anticipated personal gain of any other person.

By signing the below, Respondent certifies its ongoing adherence and understanding of the above.

Name _____

Title _____

Signature _____

Date _____